

2023

**bigblue**<sup>®</sup>

THE BRIGHTER IDEA

TAKING INNOVATION TO NEW DEPTHS

A scuba diver is shown swimming horizontally in clear blue water. The diver is wearing a black wetsuit and fins. To the left, there is a large, textured rock formation covered in green algae. Sunlight rays penetrate the water from the top right, creating a shimmering effect. The overall scene is serene and emphasizes the underwater environment.



# C o n t e n t

AL250	P.88	Camera Arms	P.112	Gloves, Hoods & Handles	P.107	VL4600P	P.36
AL250 Camouflage	P.79	Camera Clips & Accessories	P.112	HL450N	P.95	VL4600PB	P.14
AL450WM Tail	P.86	Camera Trays	P.102	HL450XW	P.95	VL6200P	P.34
AL450WM Tail Camouflage	P.78	Camera Filters	P.97	HL1000N	P.94	VL9000P Tri Color	P.32
AL450NM Tail II	P.87	CB4000P	P.48	HL1000XW	P.94	VLI1000P	P.30
AL450NM Tail II Camouflage	P.77	CB7200P	P.46	Light Filters	P.108	VLI1000PBRC	P.8
AL450 Strobe	P.75	CB7200PB	P.12	Light Head	P.69	VLI8000P Pro Mini	P.28
ALI200RAFO	P.85	CB11000P	P.44	Outdoor Dry Bags	P.110	VLI8000PBRC	P.4
ALI300NP	P.82	CB11000PBRC	P.10	Optical Fibre	P.107	VLI8000P Pro Mini Tri Color	P.26
ALI300NP Camouflage	P.76	CB16500P	P.42	Protective Case Series	P.96	VL36000P	P.24
ALI200NP IR	P.21	CB16500PBRC	P.6	RGB White II	P.89	VL36000PBRC	P.2
ALI300WP	P.83	CB30000P II	P.40	Red Spot Light & Green Spot Light	P.96	VL65000P	P.22
ALI200WP IR	P.21	CB60000P	P.38	Snoots	P.108	VTL2900P	P.59
ALI300XWP	P.84	CF450M	P.92	Sport Water Bottle	P.115	VTL2900PB	P.18
ALI300NP Tail	P.80	CF1300P	P.91	Spring Cord	P.109	VTL4200P	P.58
ALI300WP Tail	P.81	CF1800P	P.90	TL2900P	P.68	VTL4200PB	P.16
ALI300 Strobe	P.74	Chargers	P.105	TL3800P	P.67	VTL9000P	P.56
ALI800NP II	P.72	Combo Packs	P.88	TL3800P Supreme	P.66	VTL9000P Max	P.52
ALI800WP	P.73	Controller	P.107	TL5200P	P.64	VTL9000P Backmount / Sidemount	P.54
ALI800P Tri Color II	P.71	Easy Clip Lights	P.93	TL5200P Backmount / Sidemount	P.62	VTLI1000P	P.50
AL2600XWP II	P.70	Easy Release Mount Series	P.110	TL8000P	P.60		
AL2600XWPB	P.20	Float Arms, Flexi Arms	P.111				
Ambient Filters	P.106	Fluorodive Kits	P.97				
Backpack	P.114						
Batteries	P.105						



# VL36000 PBRC

36000 lumens

BUILT-IN BLUE LIGHT

BUILT-IN RED LIGHT

Slim Size

NEW



Fluorodiving Performance



**36000 LUMENS**  
**ANGLE OF LIGHT BEAM**  
**160° WIDE BEAM**

- 3 levels of brightness for cool white mode, 3 levels of brightness for blue color light, 1 level of brightness for red color mode and SOS controlled by a reliable push button design
- Battery level indicator built-in: Blue color / Green color / Red color / Flash Red color
- Easy to change up the battery pack BATCELL21700x8
- Built-in red color led enhances focusing performance
- Built-in blue color led for fluorodiving performance. Go with yellow plate for better result.
- 45pcs XML LED to provide 36000 lumens
- Comes with ball joint for easy system setup
- Place to insert the optical fibre
- Comes with protective case for VL36000PBRC
- Ergonomic aluminum handle comes in a package
- Comes with yellow plate.
- Optical fibre. Sold separately.
- Controller kit set. Sold separately.
- Set-up for the Controller.

## Li ion Rechargeable Battery Ultra Power LED Video Light with Blue Light with Remote Control Option

### SPECIFICATIONS

Light source	45 x XML LED + 10 x XPE Red LED + 16 x XPE Blue LED
Light output	9000 Lm (level I), 18000 Lm (level II), 36000 Lm (level III)
Light output ( Red color mode)	1200 Lm
Light output ( Blue color mode)	113 Lm (level I), 225 Lm (level II), 450 Lm (level III)
Casing material	Aluminum alloy. Anti-corrosive anodized
Power source	Li ion Rechargeable battery pack BATCELL21700x8
Angle of light beam	160° wide beam
Color temperature	6500K
Burn time	1.5 hrs (level III), 3 hrs (level II) and 6 hrs (level I)
Maximum depth	100 m tested
Size	Dia. 85 x L 144.6mm
Weight in air	1391 g (including battery)
Buoyancy in seawater	-597 g (including battery)
Switching system	Push button with battery indicator
Front glass	Tempered optical glass
Yellow plate	Included

### SPECIFICATIONS for CONTROLLER

Casing material	Aluminum alloy, Anti-corrosive anodized
Power source	CR2032x2
Maximum depth	100 m tested
Size	Dia. 30 x L 98.3mm
Weight in air	110 g (including battery)
Buoyancy in seawater	-51 g (including battery)
Switching system	Push button with battery indicator

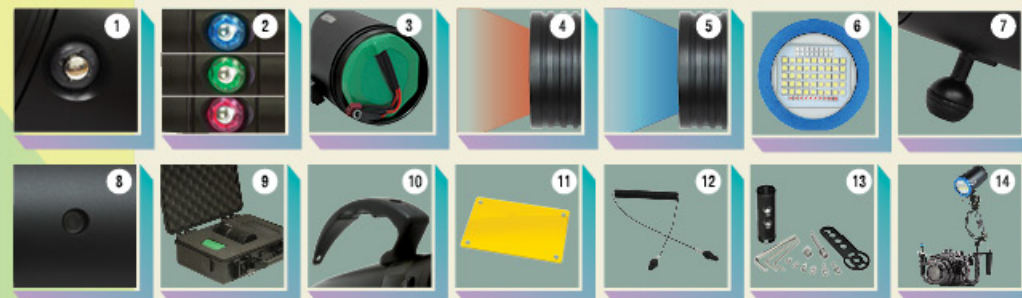



# VL18000 PBRC

18000 lumens

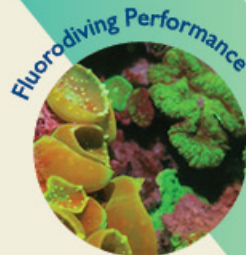

**18000 LUMENS**  
**ANGLE OF LIGHT BEAM**  
**160° WIDE BEAM**

- 3 levels of brightness for cool white mode, 3 levels of brightness for blue color light, 1 level of brightness for red color mode and SOS controlled by a reliable push button design
- Battery level indicator built-in: Blue color / Green color / Red color / Flash Red color
- BATCELL18650x7 Li ion Rechargeable Battery
- Built-in red color led enhances focusing performance
- Built-in blue color led for fluorodiving performance. Go with yellow plate for better result.
- Ergonomic aluminum handle comes in a package
- 24pcs XML LED to provide 18000 lumens
- Comes with ball joint for easy system setup
- Comes with protective case for VL 18000PBRC
- Comes with yellow plate.
- Optical fibre. Sold separately.
- Controller kit set. Sold separately.
- Set-up for the Controller.

## Li ion Rechargeable Battery Super Power LED Video Light with Blue Light with Remote Control Option

### SPECIFICATIONS

Light source	24 x XML LED + 8 x XPE Red LED + 14 x XPE Blue LED
Light output	4500 Lm (level I), 9000 Lm (level II), 18000 Lm (level III)
Light output (Red color mode)	1000 Lm
Light output (Blue color mode)	113 Lm (level I), 225 Lm (level II), 450 Lm (level III)
Casing material	Aluminum alloy. Anti-corrosive anodized
Power source	Li ion Rechargeable battery pack BATCELL18650x7
Angle of light beam	160° wide beam
Color temperature	6500K
Burn time	2 hrs (level III), 4 hrs (level II) and 8 hrs (level I)
Maximum depth	100 m tested
Size	Dia. 70 x L. 142.5mm
Weight in air	774 g (including battery)
Buoyancy in seawater	-291 g (including battery)
Switching system	Push button with battery indicator
Front glass	Tempered optical glass
Lanyard	Included
Yellow plate	Included

### SPECIFICATIONS for CONTROLLER

Casing material	Aluminum alloy, Anti-corrosive anodized
Power source	CR2032x2
Maximum depth	100 m tested
Size	Dia. 30 x L. 98.3mm
Weight in air	110 g (including battery)
Buoyancy in seawater	-51 g (including battery)
Switching system	Push button with battery indicator





# CB16500 PBRC



**16500 LUMENS**  
**ANGLE OF LIGHT BEAM**  
**160° WIDE BEAM**

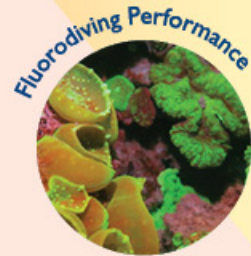

- 3 levels of brightness for warm white mode, 3 levels of brightness for blue color light, 1 level of brightness for red color mode and SOS controlled by a reliable push button design
- Battery level indicator built-in: Blue color /Green color / Red color / Flash Red color
- BATCELL18650x7 Li ion Rechargeable Battery
- Built-in red color led enhances focusing performance
- Built-in blue color led for fluorodiving performance. Go with yellow plate for better result.
- COB LED to provide 16500 lumens
- Comes with ball joint for easy system setup
- Place to insert the optical fibre.
- Comes with protective case for CB 16500PBRC.
- Ergonomic aluminum handle comes in a package
- Comes with yellow plate.
- Optical fibre. Sold separately.
- Controller kit set. Sold separately.
- Set-up for the Controller.

## Li ion Rechargeable Battery Super Power LED Video Light with High Color Rendering Index with Blue Light with Remote Control Option

### SPECIFICATIONS

Light source	COB LED + 8 x XPE Red LED + 8 x XPE Blue LED
Light output	4125 Lm (level I), 8250 Lm (level II), 16500 Lm (level III)
Light output (Red color mode)	1000 Lm
Light output (Blue color mode)	55 Lm (level I), 110 Lm (level II), 220 Lm (level III)
Casing material	Aluminum alloy, Anti-corrosive anodized
Power source	Li ion Rechargeable battery pack BATCELL18650x7
Angle of light beam	160° wide beam
Color temperature	5000K
Color Rendering Index	Ra85
Burn time	1.5 hrs (level III), 3 hrs (level II) and 6 hrs (level I)
Maximum depth	100 m tested
Size	Dia. 70 x L. 142.5mm
Weight in air	787 g (including battery)
Buoyancy in seawater	-304 g (including battery)
Switching system	Push button with battery indicator
Front glass	Tempered optical glass
Lanyard	Included
Yellow plate	Included

### SPECIFICATIONS for CONTROLLER

Casing material	Aluminum alloy, Anti-corrosive anodized
Power source	CR2032x2
Maximum depth	100 m tested
Size	Dia. 30 x L. 98.3mm
Weight in air	110 g (including battery)
Buoyancy in seawater	-51 g (including battery)
Switching system	Push button with battery indicator





# VL11000 PBRC

11000 lumens

BUILT-IN BLUE LIGHT

BUILT-IN RED LIGHT

RECHARGEABLE LIGHT HEAD

ERM EASY RELEASE MOUNT

Upgraded



- 3 levels of brightness for cool white mode, 3 levels of brightness for blue color light, 1 level of brightness for red color mode and SOS controlled by a reliable push button design
- Battery level indicator built-in: Blue color /Green color / Red color / Flash Red color
- BATCELL18650x4 Li ion Rechargeable Battery
- Built-in red color led enhances focusing performance
- Built-in blue color led for fluorodiving performance. Go with yellow plate for better result.
- Comes with ball joint for easy system setup
- Removable yellow filter enhances warmer color tone
- Sturdy glove for hands-free operation underwater
- Comes with yellow plate.
- Comes with random color outdoor dry bag
- Optical fibre. Sold separately.
- Controller kit set. Sold separately.
- Set-up for the Controller.

## Li ion Rechargeable Battery High Power LED Video Light with Blue Light with Remote Control Option

### SPECIFICATIONS

Light source	15 x XML LED + 6 x XPE Red LED + 8 x XPE Blue LED
Light output	2750 Lm (level I), 5500 Lm (level II), 11000 Lm (level III)
Light output (Red color mode)	500 Lm
Light output (Blue color mode)	55 Lm (level I), 110 Lm (level II), 220 Lm (level III)
Casing material	Aluminum alloy Anti-corrosive anodized
Power source	Li ion Rechargeable battery pack BATCELL18650x4
Angle of light beam	120° wide beam
Color temperature	6500K
Burn time	2.5 hrs (level III), 5 hrs (level II) and 10 hrs (level I)
Maximum depth	100 m tested
Size	Dia. 55.4 x L. 130.6mm
Weight in air	467 g (including battery)
Buoyancy in seawater	-184 g (including battery)
Switching system	Push button with battery indicator
Front glass	Tempered optical glass
Lanyard	Included
Yellow plate	Included

### SPECIFICATIONS for CONTROLLER

Casing material	Aluminum alloy, Anti-corrosive anodized
Power source	CR2032x2
Maximum depth	100 m tested
Size	Dia. 30 x L. 98.3mm
Weight in air	110 g (including battery)
Buoyancy in seawater	-51 g (including battery)
Switching system	Push button with battery indicator





# CB11000 PBRC



Fluorodiving Performance



- 3 levels of brightness for warm white mode, 3 levels of brightness for blue color light, 1 level of brightness for red color mode and SOS controlled by a reliable push button design
- Battery level indicator built-in: Blue color / Green color / Red color / Flash Red color
- BATCELL21700x4 Li ion Rechargeable Battery
- Built-in red color led enhances focusing performance
- Built-in blue color led for fluorodiving performance. Go with yellow plate for better result.
- Comes with ball joint for easy system setup
- Place to insert the optical fibre.
- Snoot connector for CB 11000PBRC. Sold separately.
- Sturdy glove for hands-free operation underwater
- Comes with yellow plate.
- Comes with random color outdoor dry bag
- Optical fibre. Sold separately.
- Controller kit set. Sold separately.
- Set-up for the Controller.

## Li ion Rechargeable Battery High Power LED Video Light with High Color Rendering Index with Blue Light with Remote Control Option

### SPECIFICATIONS

Light source	COB LED + 6 x XPE Red LED + 8 x XPE Blue LED
Light output	2750 Lm (level I) 5500 Lm (level II), 11000 Lm (level III)
Light output (Red color mode)	500 Lm
Light output (Blue color mode)	55 Lm (level I), 110 Lm (level II), 220 Lm (level III)
Casing material	Aluminum alloy, Anti-corrosive anodized
Power source	Li ion Rechargeable battery pack BATCELL21700x4
Angle of light beam	120° wide beam
Color temperature	5000K
Color Rendering Index	Ra85
Burn time	1.5 hrs (level III), 3 hrs (level II) and 6 hrs (level I)
Maximum depth	100 m tested
Size	Dia. 63 x L. 140.6mm
Weight in air	679 g (including battery)
Buoyancy in seawater	-283g (including battery)
Switching system	Push button with battery indicator
Front glass	Tempered optical glass
Lanyard	Included
Yellow plate	Included

### SPECIFICATIONS for CONTROLLER

Casing material	Aluminum alloy, Anti-corrosive anodized
Power source	CR2032x2
Maximum depth	100 m tested
Size	Dia. 30 x L. 98.3mm
Weight in air	110 g (including battery)
Buoyancy in seawater	-51 g (including battery)
Switching system	Push button with battery indicator





# CB7200 PB

7200 lumens



Fluorodiving Performance

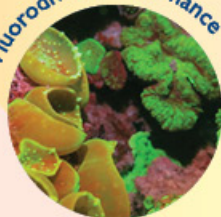

- 3 levels of brightness for warm white mode, 3 levels of brightness for blue color light, 1 level of brightness for red color mode and SOS controlled by a reliable push button design
- Battery level indicator built-in: Blue color / Green color / Red color / Flash Red color
- BATCELL21700x4 Li ion Rechargeable Battery
- Built-in red color led enhances focusing performance
- Built-in blue color led for fluorodiving performance. Go with yellow plate for better result.
- Snoot connector for CB 7200PB. Sold separately.
- Sturdy glove for hands-free operation underwater
- Comes with ball joint for easy system setup
- Comes with random color outdoor dry bag
- Comes with yellow plate.

## Li ion Rechargeable Battery High Power LED Video Light with High Color Rendering Index with Blue Light

### SPECIFICATIONS

Light source	COB LED + 6 x XPE Red LED + 8 x XPE Blue LED
Light output	1800 Lm (level I), 3600 Lm (level II), 7200 Lm (level III)
Light output (Red color mode)	500 Lm
Light output (Blue color mode)	55 Lm (level I), 110 Lm (level II), 220 Lm (level III)
Casing material	Aluminum alloy. Anti-corrosive anodized
Power source	Li ion Rechargeable battery pack BATCELL 21700x4
Angle of light beam	120° wide beam
Color temperature	5000K
Color Rendering Index	Ra 85
Burn time	2 hrs (level III), 4 hrs (level II) and 8 hrs (level I)
Maximum depth	100 m tested
Size	Dia. 63 x L. 134.6mm
Weight in air	653g (including battery)
Buoyancy in seawater	-272g (including battery)
Switching system	Push button with battery indicator
Front glass	Tempered optical glass
Lanyard	Included
Yellow plate	Included





# VL4600 PB

4600  
lumens



Fluorodiving Performance

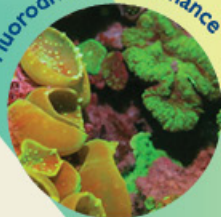

- 3 levels of brightness for cool white mode, 3 levels of brightness for blue color light, 1 level of brightness for red color mode and SOS controlled by a reliable push button design
- Battery level indicator built-in: Blue color / Green color / Red color / Flash Red color
- BATCELL36250 Li ion Rechargeable Battery
- Built-in red color led enhances focusing performance
- Built-in blue color led for fluorodiving performance. Go with yellow plate for better result.
- Comes with ball joint for easy system setup
- Sturdy glove for hands-free operation underwater
- Removable yellow filter enhances warmer color tone
- Comes with USB charger
- Comes with random color outdoor dry bag
- Comes with yellow plate.

## Li ion Rechargeable Battery LED Video Light with Blue Light

### SPECIFICATIONS

Light source	6 x XML LED + 4 x XPE Red LED + 4 x XPE Blue LED
Light output	1150 Lm (level I), 2300 Lm (level II) 4600 Lm (level III)
Light output (Red color mode)	300 Lm
Light output (Blue color mode)	30 Lm (level I), 60 Lm (level II) 120 Lm (level III)
Casing material	Aluminum alloy. Anti-corrosive anodized
Power source	Li ion Rechargeable battery pack 32650
Angle of light beam	120° wide beam
Color temperature	6500K
Burn time	1.5 hrs (level III), 3 hrs (level II) and 6 hrs (level I)
Maximum depth	100 m tested
Size	Dia. 44 x L. 121.1 mm
Weight in air	318 g (including battery)
Buoyancy in seawater	-167 g (including battery)
Switching system	Push button with battery indicator
Front glass	Tempered optical glass
Lanyard	Included
Yellow plate	Included

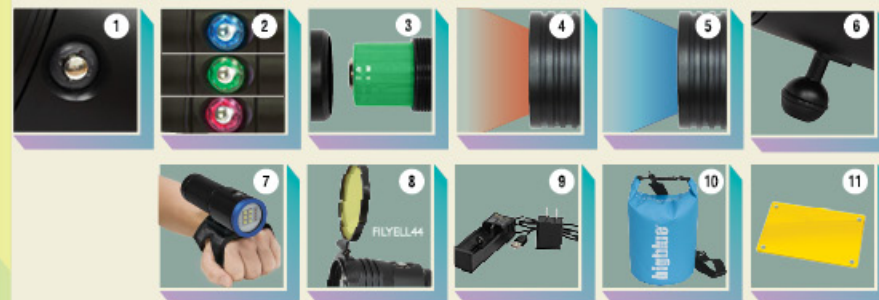



# VTL4200 PB

4200 / 1300  
Lumens / Lumens  
WIDE SPOT

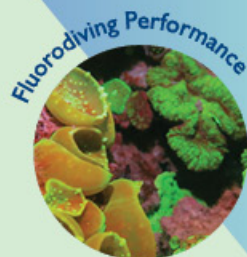

**120° WIDE BEAM**  
**10° NARROW BEAM**

- 3 levels of brightness for cool white mode, 3 levels of brightness for blue color light, 1 level of brightness for spot beam mode and 1 level of brightness for red color mode controlled by a reliable push button design
- Battery level indicator built-in: Blue color / Green color / Red color / Flash Red color
- Angle of light beam
- BATCELL36250 Li ion Rechargeable Battery
- Built-in red color led enhances focusing performance
- Built-in blue color led for fluorodiving performance. Go with yellow plate for better result.
- Sturdy glove for hands-free operation underwater
- Comes with ball joint for easy system setup
- Removable yellow filter enhances warmer color tone
- Comes with USB charger
- Comes with random color outdoor dry bag
- Comes with yellow plate.

## Li ion Rechargeable Battery LED Video / Tech Light with Blue Light

### SPECIFICATIONS

Light source	7 x XML LED + 2 x XBD Red LED + 4 x XBD Blue LED
Light output ( Flood beam mode)	1050 Lm (level I), 2100 Lm (level II) 4200 Lm (level III)
Light output ( Spot beam mode)	1300 Lm
Light output ( Red color mode)	150 Lm
Light output ( Blue color mode)	20 Lm (level I), 40 Lm (level II) 80 Lm (level III)
Casing material	Aluminum alloy. Anti-corrosive anodized
Power source	Li ion Rechargeable battery pack 32650
Angle of light beam	120° wide beam and 10° narrow beam
Color temperature	6500K
Burn time	1.5 hrs (level III), 3 hrs (level II) and 6 hrs (level I)
Maximum depth	100 m tested
Size	Dia. 55.5 x L. 140.6 mm
Weight in air	432 g (including battery)
Buoyancy in seawater	-205 g (including battery)
Switching system	Push button with battery indicator
Front glass	Tempered optical glass
Lanyard	Included
Yellow plate	Included





# VTL2900 PB

2900 / 1000  
Lumens / Lumens  
WIDE SPOT



ERM  
EASY RELEASE  
MOUNT



Fluorodiving Performance



100° WIDE BEAM  
10° NARROW BEAM

- 3 levels of brightness for cool white mode, 3 levels of brightness for blue color light, 1 level of brightness for spot beam mode and 1 level of brightness for red color mode controlled by a reliable push button design
- Battery level indicator built-in: Blue color / Green color / Red color / Flash Red color
- Angle of light beam
- BATCELL36250 Li ion Rechargeable Battery
- Built-in red color led enhances focusing performance
- Built-in blue color led for fluorodiving performance. Go with yellow plate for better result.
- Sturdy glove for hands-free operation underwater
- Comes with ball joint for easy system setup
- Removable yellow filter enhances warmer color tone
- Comes with USB charger
- Comes with random color outdoor dry bag
- Comes with yellow plate.

## Li ion Rechargeable Battery LED Video / Tech Light with Blue Light

### SPECIFICATIONS

Light source	7 x LED + 2 x XBD Red LED + 2 x XBD Blue LED
Light output ( Flood beam mode)	725 Lm (level I), 1450 Lm (level II) 2900 Lm (level III)
Light output ( Spot beam mode)	1000 Lm
Light output ( Red color mode)	100 Lm
Light output ( Blue color mode)	10 Lm (level I), 20 Lm (level II) 40 Lm (level III)
Casing material	Aluminum alloy. Anti-corrosive anodized
Power source	Li ion Rechargeable battery pack 32650
Angle of light beam	100° wide beam and 10° narrow beam
Color temperature	6500K
Burn time	1.5 hrs (level III), 3 hrs (level II) and 6 hrs (level I)
Maximum depth	100 m tested
Size	Dia. 44 x L. 128.7 mm
Weight in air	339 g (including battery)
Buoyancy in seawater	-177 g (including battery)
Switching system	Push button with battery indicator
Front glass	Tempered optical glass
Lanyard	Included
Yellow plate	Included





# AL2600 Black Molly VB

## XWPB



Fluorodiving Performance

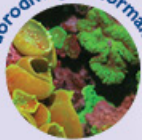

### SPECIFICATIONS

Light source	4 x XML LED + 2 x XPE Red LED + 2 x XPE Blue LED
Light output	650 Lm (level I), 1300 Lm (level II), 2600 Lm (level III)
Light output (Red color mode)	150 Lm
Light output (Blue color mode)	15 Lm (level I), 30 Lm (level II), 60 Lm (level III)
Casing material	Aluminum alloy. Anti-corrosive anodized
Power source	Li ion Rechargeable battery pack BATCELL 26650
Angle of light beam	120° wide beam
Color temperature	6500K
Burn time	2 hrs (level III), 4 hrs (level II) and 8 hrs (level I)
Maximum depth	100 m tested
Size	Dia. 35.5 x L. 126.8mm
Weight in air	218g (including battery)
Buoyancy in seawater	-105g (including battery)
Switching system	Push button with battery indicator
Front glass	Tempered optical glass
Lanyard	Included
Yellow plate	Included

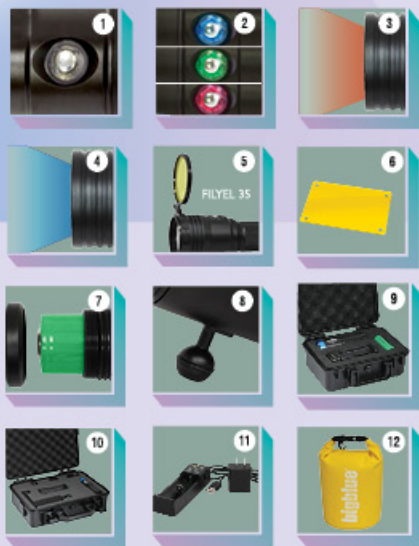

- 3 levels of brightness for cool white mode, 3 levels of brightness for blue color light, 1 level of brightness for red color mode and SOS controlled by a reliable push button design
- Battery level indicator built-in: Blue color / Green color / Red color / Flash Red color
- Built-in red color led enhances focusing performance
- Built-in blue color led for fluorodiving performance. Go with yellow plate for better result
- Removable yellow filter enhances warmer color tone
- Comes with yellow plate.
- BATCELL26650 Li ion Rechargeable Battery
- Comes with ball joint for easy system setup
- Protective case for AL 2600XWPB. Sold separately.
- Protective case for AL 2600XWPB and Single Arm Tray. Sold separately.
- Comes with USB charger
- Comes with random color outdoor dry bag

# AL1200 NPIR



### SPECIFICATIONS

Light source	IR (940nm)
Casing material	Aluminum alloy. Anti-corrosive anodized
Power source	Li ion Rechargeable battery pack 18650
Angle of light beam	10° narrow beam
Burn time	2 hrs (level IV), 5 hrs (level III) 10 hrs (level II) and 20 hrs (level I)
Maximum depth	100 m tested
Size	Dia. 33.2 x L. 139.8 mm
Weight in air	168 g (including battery)
Buoyancy in seawater	-76 g (including battery)
Switching system	Push button with battery indicator
Front glass	Tempered optical glass
Lanyard	Included



- 4 levels of brightness, and SOS controlled by a reliable push button design
- Battery level indicator built-in: Blue color / Green color / Red color / Flash Red color
- BATCELL 18650 Li ion Rechargeable Battery
- 940nm IR

# AL1200 WPIR



### SPECIFICATIONS

Light source	IR (940nm)
Casing material	Aluminum alloy. Anti-corrosive anodized
Power source	Li ion Rechargeable battery pack 18650
Angle of light beam	85° wide beam
Burn time	2 hrs (level IV), 5 hrs (level III) 10 hrs (level II) and 20 hrs (level I)
Maximum depth	100 m tested
Size	Dia. 35.5 x L. 126.3 mm
Weight in air	162 g (including battery)
Buoyancy in seawater	-84 g (including battery)
Switching system	Push button with battery indicator
Front glass	Concave lens
Lanyard	Included



- 4 levels of brightness, and SOS controlled by a reliable push button design
- Battery level indicator built-in: Blue color / Green color / Red color / Flash Red color
- BATCELL 18650 Li ion Rechargeable Battery
- Comes with random color outdoor dry bag



# VL65000P

65000  
lumens



THE MOST BRIGHTNESS  
65000 LUMENS  
ANGLE OF LIGHT BEAM  
160° WIDE BEAM

1. 4 levels of brightness, 1 level of brightness of Red color mode and SOS controlled by a reliable push button design. Press two keys at the same time to come up 100%, 50%, 25%, 10% four power level setting.
2. Battery level indicator built-in: Blue color /Green color / Red color / Flash Red color
3. 2xBATCELL60000 Li ion Rechargeable Battery
4. Built-in red color led enhances focusing performance

5. Easy to charge up the battery pack BATCELL60000
6. 72pcs XML LED to provide 65000 lumens
7. Comes with ball joint for easy system setup
8. Make use of double clip and single arm to make the handle. Comes in a package.
9. Comes with protective case for VL65000P.

## Li ion Rechargeable Battery Huge Power LED Video Light

### SPECIFICATIONS

Light source	72 x XML LED + 20 x XPE Red LED
Light output	6500 Lm (level I), 16250 Lm (level II) 32500 Lm (level III), 65000 Lm (level IV)
Light output ( Red color mode)	2000 Lm
Casing material	Aluminum alloy. Anti-corrosive anodized
Power source	Li ion Rechargeable battery pack 2xBATCELL60000
Angle of light beam	160° wide beam
Color temperature	6500K
Burn time	1.5 hrs (level IV), 3 hrs (level III) 6 hrs (level II) and 15 hrs (level I)
Maximum depth	100 m tested
Size	Dia. 120 x L. 240 mm
Weight in air	3766g (including battery)
Buoyancy in seawater	-1107g (including battery)
Switching system	Push button with battery indicator
Front glass	Tempered optical glass





# VL36000P

36000  
lumens



**highblue**  
VL36000P

**36000 LUMENS**  
**ANGLE OF LIGHT BEAM**  
**160° WIDE BEAM**

1. 4 levels of brightness | level of brightness of Red color mode and SOS controlled by a reliable push button design
2. Battery level indicator built-in: Blue color / Green color / Red color / Flash Red color
3. Easy to charge up the battery pack BATCELL 21700x8
4. Built-in red color led enhances focusing performance

5. 45pcs XML LED to provide 36000 lumens
6. Comes with ball joint for easy system setup
7. Ergonomic aluminum handle comes in a package
8. Comes with protective case for VL36000P.

## Li ion Rechargeable Battery Ultra Power LED Video Light

### SPECIFICATIONS

Light source	45 x XML LED + 10 x XPE Red LED
Light output	3600 Lm (level I), 9000 Lm (level II) 18000 Lm (level III), 36000 Lm (level IV)
Light output ( Red color mode)	1200 Lm
Casing material	Aluminum alloy. Anti-corrosive anodized
Power source	Li ion Rechargeable battery pack BATCELL21700x8
Angle of light beam	160° wide beam
Color temperature	6500K
Burn time	1.5 hrs (level IV), 3 hrs (level III) 6 hrs (level II) and 15 hrs (level I)
Maximum depth	100 m tested
Size	Dia. 85 x L. 144.6 mm
Weight in air	1391g (including battery)
Buoyancy in seawater	-597g (including battery)
Switching system	Push button with battery indicator
Front glass	Tempered optical glass

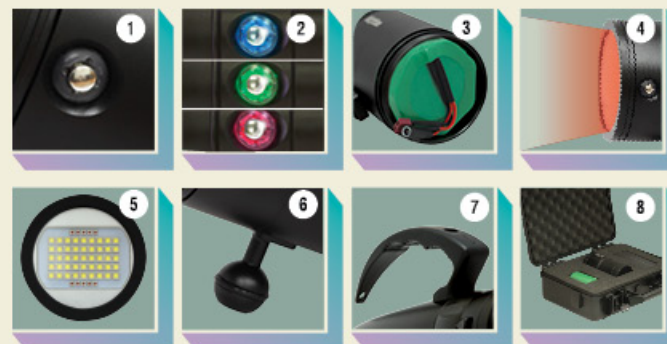



# VL18000 P

PRO MINI  
TRI COLOR

18000  
lumens



**18000 LUMENS**  
**ANGLE OF LIGHT BEAM**  
**160° WIDE BEAM**

- 3 Levels of brightness for cool white mode, 3 Levels of brightness for warm white mode, 1 level of brightness of Red color mode, and SOS controlled by a reliable push button design
- Battery level indicator built-in: Blue color / Green color / Red color / Flash Red color
- BATCELL18650x7 Li ion Rechargeable Battery
- Built-in red color led enhances focusing performance
- Built-in yellow color led enhances warmer color tone
- Ergonomic aluminum handle comes in a package
- FILFLUORO15000 Fluorodive filter for VL 18000P Pro Mini Tri Color. Sold separately.
- Comes with ball joint for easy system setup
- Comes with protective case for VL 18000P Pro Mini Tri Color.

## Li ion Rechargeable Battery Super Power LED Video Light with Three Color Output

### SPECIFICATIONS

Light source	32 x XML LED + 8 x XPE Red LED
Light output (Cool white mode)	4500 Lm (level I), 9000 Lm (level II) 18000 Lm (level III)
Light output (Warm white mode)	2000 Lm (level I), 4000 Lm (level II) 8000 Lm (level III)
Light output (Red color mode)	1000 Lm
Casing material	Aluminum alloy. Anti-corrosive anodized
Power source	Li ion Rechargeable battery pack BATCELL18650x7
Angle of light beam	160° wide beam
Color temperature	6500K cool white and 5500K warm white
Burn time	2 hrs (level III), 4 hrs (level II) and 8 hrs (level I)
Maximum depth	100 m tested
Size	Dia. 70 x L. 136mm
Weight in air	772 g (including battery)
Buoyancy in seawater	-313 g (including battery)
Switching system	Push button with battery indicator
Front glass	Tempered optical glass
Lanyard	Included

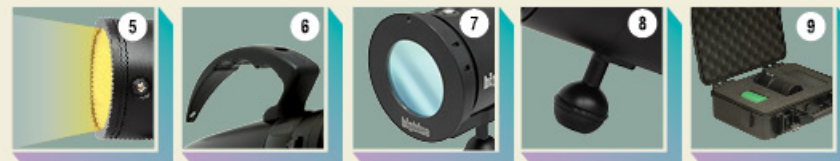



# VL18000 P | PRO MINI

18000  
lumens



**18000 LUMENS**  
**ANGLE OF LIGHT BEAM**  
**160° WIDE BEAM**

- 4 levels of brightness, 1 level of brightness of Red color mode and SOS controlled by a reliable push button design
- Battery level indicator built-in: Blue color / Green color / Red color / Flash Red color
- BATCELL I8650x7 Li ion Rechargeable Battery
- Built-in red color led enhances focusing performance
- 24pcs XML LED to provide 18000 lumens
- Ergonomic aluminum handle comes in a package
- FILFLUORO I5000 Fluorodive filter for VL 18000P Pro Mini. Sold separately.
- Comes with ball joint for easy system setup
- Comes with protective case for VL 18000P Pro Mini.

## Li ion Rechargeable Battery Super Power LED Video Light

### SPECIFICATIONS

Light source	24 x XML LED + 8 x XPE Red LED
Light output	1800 Lm (level I), 4500 Lm (level II) 9000 Lm (level III), 18000 Lm (level IV)
Light output (Red color mode)	1000 Lm
Casing material	Aluminum alloy. Anti-corrosive anodized
Power source	Li ion Rechargeable battery pack BATCELL I8650x7
Angle of light beam	160° wide beam
Color temperature	6500K
Burn time	2 hrs (level IV), 4 hrs (level III) 8 hrs (level II) and 20 hrs (level I)
Maximum depth	100 m tested
Size	Dia. 70 x L. 136mm
Weight in air	757 g (including battery)
Buoyancy in seawater	-298 g (including battery)
Switching system	Push button with battery indicator
Front glass	Tempered optical glass
Lanyard	Included

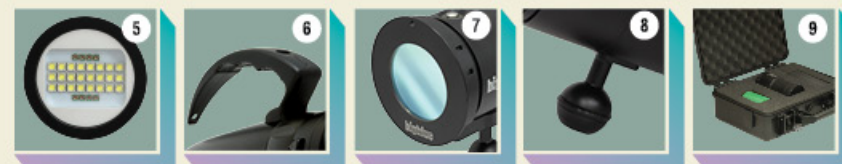



# VL11000P

11000  
lumens



1. 4 Levels of brightness, 1 level of brightness of Red color mode and SOS controlled by a reliable push button design
2. Battery level indicator built-in: Blue color /Green color / Red color / Flash Red color
3. BATCELL18650x4 Li ion Rechargeable Battery
4. Built-in red color led enhances focusing performance

5. Removable yellow filter enhances warmer color tone
6. Sturdy glove for hands-free operation underwater
7. Comes with ball joint for easy system setup
8. Comes with random color outdoor dry bag

## Li ion Rechargeable Battery High Power LED Video Light

### SPECIFICATIONS

Light source	15 x XML LED + 6 x XPE Red LED
Light output	1100 Lm (level I), 2750 Lm (level II) 5500 Lm (level III), 11000 Lm (level IV)
Light output ( Red color mode)	500 Lm
Casing material	Aluminum alloy. Anti-corrosive anodized
Power source	Li ion Rechargeable battery pack BATCELL18650x4
Angle of light beam	120° wide beam
Color temperature	6500K
Burn time	2.5 hrs (level IV), 5 hrs (level III) 10 hrs (level II) and 25 hrs (level I)
Maximum depth	100 m tested
Size	Dia. 55.4 x L. 130.6mm
Weight in air	457g (including battery)
Buoyancy in seawater	-173g (including battery)
Switching system	Push button with battery indicator
Front glass	Tempered optical glass
Lanyard	Included





# VL9000 P | TRI COLOR

9000  
lumens



- 3 Levels of brightness for cool white mode, 3 Levels of brightness for warm white mode, 1 level of brightness of Red color mode and SOS controlled by a reliable push button design
- Battery level indicator built-in: Blue color / Green color / Red color / Flash Red color
- BATCELL I8650x4 Li ion Rechargeable Battery

- Built-in red color led enhances focusing performance
- Built-in yellow color led enhances warmer color tone
- Sturdy glove for hands-free operation underwater
- Comes with ball joint for easy system setup
- Comes with random color outdoor dry bag

## Li ion Rechargeable Battery High Power LED Video Light with Three Color Output

### SPECIFICATIONS

Light source	15 x XML LED + 6 x XPE Red LED
Light output (Cool white mode)	2250 Lm (level I), 4500 Lm (level II) 9000 Lm (level III)
Light output (Warm white mode)	1125 Lm (level I), 2250 Lm (level II) 4500 Lm (level III)
Light output (Red color mode)	500 Lm
Casing material	Aluminum alloy. Anti-corrosive anodized
Power source	Li ion Rechargeable battery pack BATCELL I8650x4
Angle of light beam	120° wide beam
Color temperature	6500K cool white and 5500K warm white
Burn time	3 hrs (level III), 6 hrs (level II) and 12 hrs (level I)
Maximum depth	100 m tested
Size	Dia. 55.4 x L. 130.6mm
Weight in air	457 g (including battery)
Buoyancy in seawater	-173 g (including battery)
Switching system	Push button with battery indicator
Front glass	Tempered optical glass
Lanyard	Included





# VL6200P

6200 lumens



1. 4 Levels of brightness, 1 level of brightness of Red color mode and SOS controlled by a reliable push button design
2. Battery level indicator built-in: Blue color /Green color / Red color / Flash Red color
3. BATCELL I8650x3 Li ion Rechargeable Battery
4. Built-in red color led enhances focusing performance

5. Sturdy glove for hands-free operation underwater
6. Comes with ball joint for easy system setup
7. Comes with random color outdoor dry bag

## Li ion Rechargeable Battery LED Video Light

### SPECIFICATIONS

Light source	6 x XML LED + 4 x XBD Red LED
Light output	620 Lm (level I), 1550 Lm (level II) 3100 Lm (level III), 6200 Lm (level IV)
Light output (Red color mode)	300 Lm
Casing material	Aluminum alloy. Anti-corrosive anodized
Power source	Li ion Rechargeable battery pack BATCELL I 8650x3
Angle of light beam	120° wide beam
Color temperature	6500K
Burn time	1.5 hrs (level IV), 3 hrs (level III) 6 hrs (level II) and 15 hrs (level I)
Maximum depth	100 m tested
Size	Dia. 50 x L. 126.6mm
Weight in air	381 g (including battery)
Buoyancy in seawater	-163g (including battery)
Switching system	Push button with battery indicator
Front glass	Tempered optical glass
Lanyard	Included





# VL4600<sub>P</sub>

4600  
lumens



Available in 3 colors

1. 4 levels of brightness for Flood beam mode, 1 level of brightness of Red color mode and SOS controlled by a reliable push button design
2. Battery level indicator built-in: Blue color /Green color / Red color / Flash Red color
3. BATCELL 32650 Li ion Rechargeable Battery
4. Built-in red color led enhances focusing performance

5. Comes with ball joint for easy system setup
6. Removable yellow filter enhances warmer color tone
7. Sturdy glove for hands-free operation underwater
8. Comes with USB charger
9. Comes with random color outdoor dry bag

## Li ion Rechargeable Battery LED Video Light

### SPECIFICATIONS

Light source	6 x XML LED + 4 x XPE Red LED
Light output (Flood beam mode)	460 Lm (level I), 1150 Lm (level II) 2300 Lm (level III), 4600 Lm (level IV)
Light output (Red color mode)	300 Lm
Casing material	Aluminum alloy. Anti-corrosive anodized
Power source	Li ion Rechargeable battery pack 32650
Angle of light beam	120° wide beam
Color temperature	6500K
Burn time	1.5 hrs (level IV), 3 hrs (level III) 6 hrs (level II) and 15 hrs (level I)
Maximum depth	100 m tested
Size	Dia. 44 x L. 121.1 mm
Weight in air	318 g (including battery)
Buoyancy in seawater	-167 g (including battery)
Switching system	Push button with battery indicator
Front glass	Tempered optical glass
Lanyard	Included





# CB60000P

60000  
lumens



**60000 LUMENS**  
**ANGLE OF LIGHT BEAM**  
**160° WIDE BEAM**

1. 4 levels of brightness, 1 level of brightness of Red color mode and SOS controlled by a reliable push button design. Press two keys at the same time to come up 100%, 50%, 25%, 10% four power level setting.
2. Battery level indicator built-in: Blue color / Green color / Red color / Flash Red color
3. 2x BATCELL60000 Li ion Rechargeable Battery
4. Built-in red color led enhances focusing performance
5. Easy to charge up the battery pack BATCELL60000
6. COB LED to provide 60000 lumens
7. Comes with ball joint for easy system setup
8. Make use of double clip and single arm to make the handle. Comes in a package.
9. Comes with protective case for CB 60000P.

## Li ion Rechargeable Battery Huge Power LED Video Light with High Color Rendering Index

### SPECIFICATIONS

Light source	COB LED + 20 x XPE Red LED
Light output	6000 Lm (level I), 15000 Lm (level II) 30000 Lm (level III), 60000 Lm (level IV)
Light output ( Red color mode)	2000 Lm
Casing material	Aluminum alloy. Anti-corrosive anodized
Power source	Li ion Rechargeable battery pack 2x BATCELL60000
Angle of light beam	160° wide beam
Color temperature	5000K
Color Rendering Index	Ra 85
Burn time	1.5 hrs (level IV), 3 hrs (level III) 6 hrs (level II) and 15 hrs (level I)
Maximum depth	100 m tested
Size	Dia. 120 x L. 240 mm
Weight in air	3766g (including battery)
Buoyancy in seawater	-1107g (including battery)
Switching system	Push button with battery indicator
Front glass	Tempered optical glass





# CB30000 P II

30000  
lumens



Slim  
Size



**30000 LUMENS**  
**ANGLE OF LIGHT BEAM**  
**160° WIDE BEAM**

1. 4 levels of brightness | level of brightness of Red color mode and SOS controlled by a reliable push button design
2. Battery level indicator built-in: Blue color / Green color / Red color / Flash Red color
3. BATCELL21700x8 Li ion Rechargeable Battery
4. Built-in red color led enhances focusing performance
5. COB LED to provide 30000 lumens
6. Comes with ball joint for easy system setup
7. Ergonomic aluminum handle comes in a package
8. Comes with protective case for CB30000P II.

## Li ion Rechargeable Battery Ultra Power LED Video Light with High Color Rendering Index

### SPECIFICATIONS

Light source	COB LED + 10 x XPE Red LED
Light output	3000 Lm (level I), 7500 Lm (level II) 15000 Lm (level III), 30000 Lm (level IV)
Light output ( Red color mode)	1200 Lm
Casing material	Aluminum alloy. Anti-corrosive anodized
Power source	Li ion Rechargeable battery pack BATCELL21700x8
Angle of light beam	160° wide beam
Color temperature	5000K
Color Rendering Index	Ra 85
Burn time	1.5 hrs (level IV), 3 hrs (level III) 6 hrs (level II) and 15 hrs (level I)
Maximum depth	100 m tested
Size	Dia. 85 x L. 144.6mm
Weight in air	1391 g (including battery)
Buoyancy in seawater	-597g (including battery)
Switching system	Push button with battery indicator
Front glass	Tempered optical glass





# CB16500P

16500  
lumens



Upgraded



**16500 LUMENS**  
**ANGLE OF LIGHT BEAM**  
**160° WIDE BEAM**

- 4 levels of brightness 1 level of brightness of Red color mode and SOS controlled by a reliable push button design
- Battery level indicator built-in: Blue color / Green color / Red color / Flash Red color
- BATCELL18650x7 Li ion Rechargeable Battery
- Built-in red color led enhances focusing performance
- COB LED to provide 16500 lumens
- Comes with ball joint for easy system setup
- Ergonomic aluminum handle comes in a package
- Comes with protective case for CB16500P.
- FILFLUORO15000 Fluorodive filter for CB16500P. Sold separately.

## Li ion Rechargeable Battery Super Power LED Video Light with High Color Rendering Index

### SPECIFICATIONS

Light source	COB LED + 8 x XPE Red LED
Light output	1650 Lm (level I), 4125 Lm (level II) 8250 Lm (level III), 16500 Lm (level IV)
Light output ( Red color mode)	1000 Lm
Casing material	Aluminum alloy. Anti-corrosive anodized
Power source	Li ion Rechargeable battery pack BATCELL18650x7
Angle of light beam	160° wide beam
Color temperature	5000K
Color Rendering Index	Ra 85
Burn time	1.5 hrs (level IV), 3 hrs (level III) 6 hrs (level II) and 15 hrs (level I)
Maximum depth	100 m tested
Size	Dia. 70 x L. 136mm
Weight in air	776g (including battery)
Buoyancy in seawater	-317g (including battery)
Switching system	Push button with battery indicator
Front glass	Tempered optical glass
Lanyard	Included



# CB11000 P

11000  
lumens



1. 4 levels of brightness 1 level of brightness of Red color mode and SOS controlled by a reliable push button design
2. Battery level indicator built-in: Blue color / Green color / Red color / Flash Red color
3. BATCELL21700x4 Li ion Rechargeable Battery
4. Built-in red color led enhances focusing performance
5. Snoot connector for CB 11000P. Sold separately.
6. Sturdy glove for hands-free operation underwater
7. Comes with ball joint for easy system setup
8. Comes with random color outdoor dry bag

## Li ion Rechargeable Battery High Power LED Video Light with High Color Rendering Index

### SPECIFICATIONS

Light source	COB LED + 6 x XPE Red LED
Light output	1100 Lm (level I), 2750 Lm (level II) 5500 Lm (level III), 11000 Lm (level IV)
Light output ( Red color mode)	500 Lm
Casing material	Aluminum alloy. Anti-corrosive anodized
Power source	Li ion Rechargeable battery pack BATCELL 21700x4
Angle of light beam	120° wide beam
Color temperature	5000K
Color Rendering Index	Ra 85
Burn time	1.5 hrs (level IV), 3 hrs (level III) 6 hrs (level II) and 15 hrs (level I)
Maximum depth	100 m tested
Size	Dia. 63 x L. 134.6mm
Weight in air	654g (including battery)
Buoyancy in seawater	-273g (including battery)
Switching system	Push button with battery indicator
Front glass	Tempered optical glass
Lanyard	Included





# CB7200P

7200  
lumens



1. 4 levels of brightness | level of brightness of Red color mode and SOS controlled by a reliable push button design
2. Battery level indicator built-in: Blue color / Green color / Red color / Flash Red color
3. BATCELL21700x4 Li ion Rechargeable Battery
4. Built-in red color led enhances focusing performance

5. Snoot connector for CB 7200P. Sold separately.
6. Sturdy glove for hands-free operation underwater
7. Comes with ball joint for easy system setup
8. Comes with random color outdoor dry bag

## Li ion Rechargeable Battery High Power LED Video Light with High Color Rendering Index

### SPECIFICATIONS

Light source	COB LED + 6 x XPE Red LED
Light output	720 Lm (level I), 1800 Lm (level II) 3600 Lm (level III), 7200 Lm (level IV)
Light output ( Red color mode)	500 Lm
Casing material	Aluminum alloy. Anti-corrosive anodized
Power source	Li ion Rechargeable battery pack BATCELL 21700x4
Angle of light beam	120° wide beam
Color temperature	5000K
Color Rendering Index	Ra 85
Burn time	2 hrs (level IV), 4 hrs (level III) 8 hrs (level II) and 20 hrs (level I)
Maximum depth	100 m tested
Size	Dia. 63 x L. 134.6mm
Weight in air	653g (including battery)
Buoyancy in seawater	-272g (including battery)
Switching system	Push button with battery indicator
Front glass	Tempered optical glass
Lanyard	Included

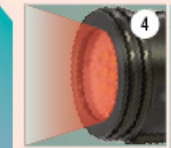
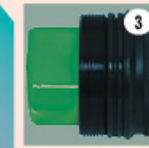
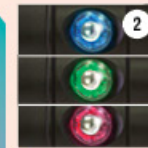
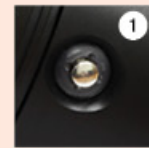

# CB4000P

4000  
lumens



1. 4 levels of brightness | level of brightness of Red color mode and SOS controlled by a reliable push button design
2. Battery level indicator built-in: Blue color / Green color / Red color / Flash Red color
3. BATCELL 18650x3 Li ion Rechargeable Battery
4. Built-in red color led enhances focusing performance

5. Snoot connector for CB 4000P. Sold separately.
6. Sturdy glove for hands-free operation underwater
7. Comes with ball joint for easy system setup
8. Comes with random color outdoor dry bag

## Li ion Rechargeable Battery LED Video Light with High Color Rendering Index

### SPECIFICATIONS

Light source	COB LED + 4 x XPE Red LED
Light output	400 Lm (level I), 1000 Lm (level II) 2000 Lm (level III), 4000 Lm (level IV)
Light output (Red color mode)	300 Lm
Casing material	Aluminum alloy. Anti-corrosive anodized
Power source	Li ion Rechargeable battery pack BATCELL 18650x3
Angle of light beam	120° wide beam
Color temperature	5000K
Color Rendering Index	Ra 85
Burn time	1.5 hrs (level IV), 3 hrs (level III) 6 hrs (level II) and 15 hrs (level I)
Maximum depth	100 m tested
Size	Dia. 50 x L. 130.3mm
Weight in air	393g (including battery)
Buoyancy in seawater	-168g (including battery)
Switching system	Push button with battery indicator
Front glass	Tempered optical glass
Lanyard	Included





# VTL11000 P

11000 / 1300  
Lumens / Lumens  
WIDE SPOT



ERM  
EASY RELEASE  
MOUNT



120° WIDE BEAM  
10° NARROW BEAM

- 4 Levels of brightness for Flood beam mode and 1 level of brightness for Spot beam mode controlled by a reliable push button design
- Battery level indicator built-in: Blue color / Green color / Red color / Flash Red color
- Angle of light beam
- Removable red filter enhances focusing performance
- Removable yellow filter enhances warmer color tone
- Sturdy glove for hands-free operation underwater
- Comes with ball joint for easy system setup
- BATCELL18650x4 Li ion Rechargeable Battery
- Comes with random color outdoor dry bag

## Li ion Rechargeable Battery High Power LED Video / Tech Light

### SPECIFICATIONS

Light source	16 x XML LED
Light output ( Flood beam mode )	1100 Lm (level I), 2750 Lm (level II) 5500 Lm (level III), 11000 Lm (level IV)
Light output ( Spot beam mode)	1300 Lm
Casing material	Aluminum alloy. Anti-corrosive anodized
Power source	Li ion Rechargeable battery pack BATCELL18650x4
Angle of light beam	120° wide beam and 10° narrow beam
Color temperature	6500K
Burn time	2.5 hrs (level IV), 5 hrs (level III) 10 hrs (level II) and 25 hrs (level I)
Maximum depth	100 m tested
Size	Dia. 63 x L. 150.3mm
Weight in air	548g (including battery)
Buoyancy in seawater	-203g (including battery)
Switching system	Push button with battery indicator
Front glass	Tempered optical glass
Lanyard	Included



# VTL9000 P MAX

9000 / 2900  
Lumens / Lumens  
WIDE SPOT



ERM  
EASY RELEASE  
MOUNT



120° WIDE BEAM  
10° NARROW BEAM

- 3 Levels of brightness for Flood beam mode, 3 levels of brightness for Spot beam mode and 1 level of brightness for Red color mode controlled by a reliable push button design
- Battery level indicator built-in: Blue color / Green color / Red color / Flash Red color
- Angle of light beam
- Built-in red color led enhances focusing performance
- Removable yellow filter enhances warmer color tone
- Sturdy glove for hands-free operation underwater
- Comes with ball joint for easy system setup
- BATCELL I8650x4 Li ion Rechargeable Battery
- Comes with random color outdoor dry bag

## Li ion Rechargeable Battery High Power LED Video / Tech Light

### SPECIFICATIONS

Light source	13 x LED + 6 x XPE Red LED
Light output ( Flood beam mode )	2250 Lm (level I) 4500 Lm (level II), 9000 Lm (level III)
Light output ( Spot beam mode )	725 Lm (level I) 1450 Lm (level II), 2900 Lm (level III)
Light output ( Red color mode )	500 Lm
Casing material	Aluminum alloy. Anti-corrosive anodized
Power source	Li ion Rechargeable battery pack BATCELL I8650x4
Angle of light beam	120° wide beam and 10° narrow beam
Color temperature	6500K
Burn time	3 hrs (level III), 6 hrs (level II) and 12 hrs (level I)
Maximum depth	100 m tested
Size	Dia. 63 x L. 150.3mm
Weight in air	548g (including battery)
Buoyancy in seawater	-203g (including battery)
Switching system	Push button with battery indicator
Front glass	Tempered optical glass
Lanyard	Included





# VTL9000<sup>P</sup> Backmount

Li ion Rechargeable Battery  
High Power LED Video/Tech  
Light with Battery Canister



9000 / 1300  
Lumens / Lumens  
WIDE SPOT



120° WIDE BEAM  
10° NARROW BEAM

## SPECIFICATIONS

Light source	11 x XML LED + 6 x XPE Red LED
Light output ( Flood beam mode )	900 Lm (level I), 2250 Lm (level II) 4500 Lm (level III), 9000 Lm (level IV)
Light output ( Spot beam mode )	1300 Lm
Light output ( Red color mode )	500 Lm
Casing material	Aluminum alloy. Anti-corrosive anodized
Power source	Li ion Rechargeable battery pack BATCELLCANISTER
Angle of light beam	120° wide beam and 10° narrow beam
Color temperature	6500K
Burn time	6 hrs (level IV), 12 hrs (level III) 24 hrs (level II) and 60 hrs (level I)
Maximum depth	100 m tested
Size (Light head)	Dia. 63 x L. 106.5mm
Size (Canister)	Dia. 60 x L. 202mm
Weight in air (Light head)	317g
Weight in air (Canister)	975g
Buoyancy in seawater (Light head)	-101g
Buoyancy in seawater (Canister)	-384g
Switching system	Push button with battery indicator
Cable Length	1.2 meters
Front glass	Tempered optical glass

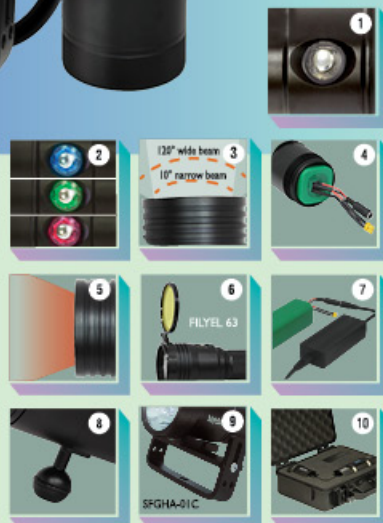

- 4 Levels of brightness for Flood beam mode, 1 levels of brightness for Spot beam mode and 1 level of brightness for Red color mode controlled by a reliable push button design
- Battery level indicator built-in: Blue color /Green color / Red color / Flash Red color
- Angle of light beam
- BATCELLCANISTER Li ion Rechargeable Battery
- Built-in red color led enhances focusing performance
- Removable yellow filter enhances warmer color tone
- Easy to charge up the battery BATCELLCANISTER
- Comes with ball joint for easy system setup
- Slim fit Goodman handle with connector. Comes in a package
- Comes with protective case for VTL 9000P Backmount.

# VTL9000<sup>P</sup> Sidemount

Li ion Rechargeable Battery  
High Power LED Video/Tech  
Light with Battery Canister



9000 / 1300  
Lumens / Lumens  
WIDE SPOT



120° WIDE BEAM  
10° NARROW BEAM

## SPECIFICATIONS

Light source	11 x XML LED + 6 x XPE Red LED
Light output ( Flood beam mode )	900 Lm (level I), 2250 Lm (level II) 4500 Lm (level III), 9000 Lm (level IV)
Light output ( Spot beam mode )	1300 Lm
Light output ( Red color mode )	500 Lm
Casing material	Aluminum alloy. Anti-corrosive anodized
Power source	Li ion Rechargeable battery pack BATCELLCANISTER
Angle of light beam	120° wide beam and 10° narrow beam
Color temperature	6500K
Burn time	6 hrs (level IV), 12 hrs (level III) 24 hrs (level II) and 60 hrs (level I)
Maximum depth	100 m tested
Size (Light head)	Dia. 63 x L. 106.5mm
Size (Canister)	Dia. 60 x L. 212mm
Weight in air (Light head)	317g
Weight in air (Canister)	1033g
Buoyancy in seawater (Light head)	-101g
Buoyancy in seawater (Canister)	-407g
Switching system	Push button with battery indicator
Cable Length	1.35 meters
Front glass	Tempered optical glass

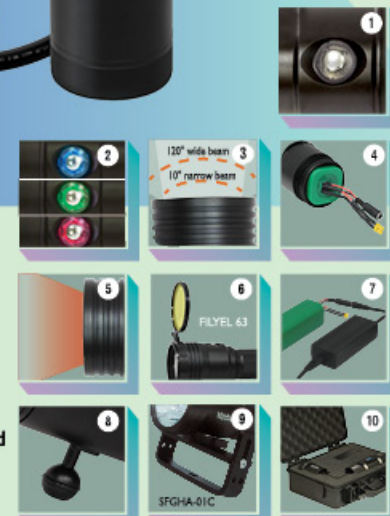

- 4 Levels of brightness for Flood beam mode, 1 levels of brightness for Spot beam mode and 1 level of brightness for Red color mode controlled by a reliable push button design
- Battery level indicator built-in: Blue color /Green color / Red color / Flash Red color
- Angle of light beam
- BATCELLCANISTER Li ion Rechargeable Battery
- Built-in red color led enhances focusing performance
- Removable yellow filter enhances warmer color tone
- Easy to charge up the battery BATCELLCANISTER
- Comes with ball joint for easy system setup
- Slim fit Goodman handle with connector. Comes in a package
- Comes with protective case for VTL 9000P Sidemount.



# VTL9000P

9000 / 1300  
Lumens / Lumens  
WIDE SPOT



**120° WIDE BEAM**  
**10° NARROW BEAM**

- 4 Levels of brightness for Flood beam mode, 1 level of brightness for Spot beam mode and 1 level of brightness for Red color mode controlled by a reliable push button design
- Battery level indicator built-in: Blue color / Green color / Red color / Flash Red color
- Angle of light beam
- Built-in red color led enhances focusing performance
- Removable yellow filter enhances warmer color tone
- Sturdy glove for hands-free operation underwater
- Comes with ball joint for easy system setup
- BATCELLI8650x4 Li ion Rechargeable Battery
- Comes with random color outdoor dry bag

## Li ion Rechargeable Battery High Power LED Video / Tech Light

### SPECIFICATIONS

Light source	11 x XML LED + 6 x XPE Red LED
Light output ( Flood beam mode )	900 Lm (level I), 2250 Lm (level II) 4500 Lm (level III), 9000 Lm (level IV)
Light output ( Spot beam mode )	1300 Lm
Light output ( Red color mode )	500 Lm
Casing material	Aluminum alloy. Anti-corrosive anodized
Power source	Li ion Rechargeable battery pack BATCELLI8650x4
Angle of light beam	120° wide beam and 10° narrow beam
Color temperature	6500K
Burn time	3 hrs (level IV), 6 hrs (level III) 12 hrs (level II) and 30 hrs (level I)
Maximum depth	100 m tested
Size	Dia. 63 x L. 150.3mm
Weight in air	548g (including battery)
Buoyancy in seawater	-203g (including battery)
Switching system	Push button with battery indicator
Front glass	Tempered optical glass
Lanyard	Included





# VTL4200P

4200 Lumens / 1300 Lumens  
WIDE SPOT



Li ion Rechargeable Battery  
LED Video / Tech Light



120° WIDE BEAM  
10° NARROW BEAM

## SPECIFICATIONS

Light source	7 x XML LED + 2 x XPE Red LED
Light output (Flood beam mode)	420 Lm (level I), 1050 Lm (level II) 2100 Lm (level III), 4200 Lm (level IV)
Light output (Spot beam mode)	1300 Lm
Light output (Red color mode)	150 Lm
Casing material	Aluminum alloy. Anti-corrosive anodized
Power source	Li ion Rechargeable battery pack 32650
Angle of light beam	120° wide beam and 10° narrow beam
Color temperature	6500K
Burn time	1.5 hrs (level IV), 3 hrs (level III) 6 hrs (level II) and 15 hrs (level I)
Maximum depth	100 m tested
Size	Dia. 55.5 x L. 140.6 mm
Weight in air	432 g (including battery)
Buoyancy in seawater	-205 g (including battery)
Switching system	Push button with battery indicator
Front glass	Tempered optical glass
Lanyard	Included

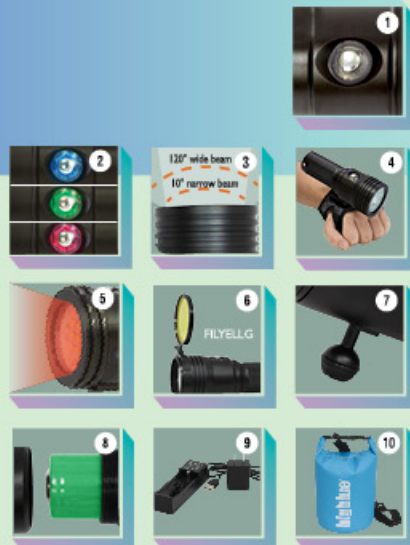

- 4 Levels of brightness for Flood beam mode, 1 level of brightness for Spot beam mode and 1 level of brightness for Red color mode controlled by a reliable push button design
- Battery level indicator built-in: Blue color /Green color /Red color /Flash Red color
- Angle of light beam
- Sturdy glove for hands-free operation underwater
- Built-in red color led enhances focusing performance.
- Removable yellow filter enhances warmer color tone
- Comes with ball joint for easy system setup
- BATCELL 32650 Li ion Rechargeable Battery
- Comes with USB charger
- Comes with random color outdoor dry bag

# VTL2900P

2900 Lumens / 1000 Lumens  
WIDE SPOT



Li ion Rechargeable Battery  
LED Video / Tech Light



100° WIDE BEAM  
10° NARROW BEAM

Available in 3 colors

## SPECIFICATIONS

Light source	7 x LED + 2 x XPE Red LED
Light output (Flood beam mode)	290 Lm (level I), 725 Lm (level II) 1450 Lm (level III), 2900 Lm (level IV)
Light output (Spot beam mode)	1000 Lm
Light output (Red color mode)	100 Lm
Casing material	Aluminum alloy. Anti-corrosive anodized
Power source	Li ion Rechargeable battery pack 32650
Angle of light beam	100° wide beam and 10° narrow beam
Color temperature	6500K
Burn time	1.5 hrs (level IV), 3 hrs (level III) 6 hrs (level II) and 15 hrs (level I)
Maximum depth	100 m tested
Size	Dia. 44 x L. 128.7 mm
Weight in air	339 g (including battery)
Buoyancy in seawater	-177 g (including battery)
Switching system	Push button with battery indicator
Front glass	Tempered optical glass
Lanyard	Included



- 4 Levels of brightness for Flood beam mode, 1 level of brightness for Spot beam mode and 1 level of brightness for Red color mode controlled by a reliable push button design
- Battery level indicator built-in: Blue color /Green color /Red color /Flash Red color
- Angle of light beam
- Sturdy glove for hands-free operation underwater
- Built-in red color led enhances focusing performance.
- Removable yellow filter enhances warmer color tone
- Comes with ball joint for easy system setup
- BATCELL 32650 Li ion Rechargeable Battery
- Comes with USB charger.
- Comes with random color outdoor dry bag

# TL8000P

8000  
lumens



1. 4 levels of brightness and SOS controlled by a reliable push button design
2. Battery level indicator built-in: Blue color / Green color / Red color / Flash Red color
3. BATCELL I8650x7 Li ion Rechargeable Battery

4. Ergonomic aluminum handle comes in a package
5. Slim fit Goodman handle with connector. Comes in a package
6. Comes with random color outdoor dry bag

## Li ion Rechargeable Battery Super Power LED Tech Light

### SPECIFICATIONS

Light source	8 x LED
Light output	800 Lm (level I), 2000 Lm (level II) 4000 Lm (level III), 8000 Lm (level IV)
Casing material	Aluminum alloy. Anti-corrosive anodized
Power source	Li ion Rechargeable battery pack BATCELL I8650x7
Angle of light beam	10° narrow beam
Color temperature	6500K
Burn time	2 hrs (level IV), 4 hrs (level III) 8 hrs (level II) and 20 hrs (level I)
Maximum depth	150 m tested
Size	Dia. 78 x L. 143.8 mm
Weight in air	830 g (including battery)
Buoyancy in sea-water	-313 g (including battery)
Switching system	Push button with battery indicator
Front glass	Tempered optical glass
Lanyard	Included

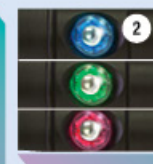
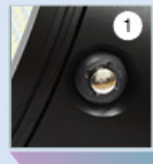



# TL5200<sup>P</sup> Backmount

Li ion Rechargeable Battery  
High Power LED Tech Light  
with Battery Canister

5200  
lumens



## SPECIFICATIONS

Light source	4 x XML LED
Light output	520 Lm (level I), 1300 Lm (level II) 2600 Lm (level III), 5200 Lm (level IV)
Casing material	Aluminum alloy. Anti-corrosive anodized
Power source	Li ion Rechargeable battery pack BATCELLCANISTER
Angle of light beam	10° narrow beam
Color temperature	6500K
Burn time	7 hrs (level IV), 14 hrs (level III) 28 hrs (level II) and 70 hrs (level I)
Maximum depth	100 m tested
Size (Light head)	Dia. 72 x L. 88.3mm
Size (Canister)	Dia. 60 x L. 202mm
Weight in air (Light head)	380g
Weight in air (Canister)	975g
Buoyancy in seawater (Light head)	-134g
Buoyancy in seawater (Canister)	-384g
Switching system	Push button with battery indicator
Cable Length	1.2 meters
Front glass	Tempered optical glass



- 4 Levels of brightness and SOS controlled by a reliable push button design
- Battery level indicator built-in: Blue color / Green color / Red color / Flash Red color
- BATCELLCANISTER Li ion Rechargeable Battery
- Slim fit Goodman handle with connector. Comes in a package
- Easy to charge up the battery BATCELLCANISTER
- Comes with protective case for TL 5200P Backmount.

# TL5200<sup>P</sup> Sidemount

Li ion Rechargeable Battery  
High Power LED Tech Light  
with Battery Canister

5200  
lumens



## SPECIFICATIONS

Light source	4 x XML LED
Light output	520 Lm (level I), 1300 Lm (level II) 2600 Lm (level III), 5200 Lm (level IV)
Casing material	Aluminum alloy. Anti-corrosive anodized
Power source	Li ion Rechargeable battery pack BATCELLCANISTER
Angle of light beam	10° narrow beam
Color temperature	6500K
Burn time	7 hrs (level IV), 14 hrs (level III) 28 hrs (level II) and 70 hrs (level I)
Maximum depth	100 m tested
Size (Light head)	Dia. 72 x L. 88.3mm
Size (Canister)	Dia. 60 x L. 212mm
Weight in air (Light head)	380g
Weight in air (Canister)	1033g
Buoyancy in seawater (Light head)	-134g
Buoyancy in seawater (Canister)	-407g
Switching system	Push button with battery indicator
Cable Length	1.35 meters
Front glass	Tempered optical glass



- 4 Levels of brightness and SOS controlled by a reliable push button design
- Battery level indicator built-in: Blue color / Green color / Red color / Flash Red color
- BATCELLCANISTER Li ion Rechargeable Battery
- Slim fit Goodman handle with connector. Comes in a package
- Easy to charge up the battery BATCELLCANISTER
- Comes with protective case for TL 5200P Sidemount.

# TL5200<sub>P</sub>

5200  
lumens



1. 4 levels of brightness and SOS controlled by a reliable push button design
2. Battery level indicator built-in: Blue color / Green color / Red color / Flash Red color
3. BATCELL18650x4 Li ion Rechargeable Battery
4. Sturdy Goodman Glove for handy Tech-dive operation

5. Ergonomic aluminum handle comes in a package
6. Goodman handle with connector or Slim fit Goodman handle with connector. Sold separately.
7. Comes with random color outdoor dry bag

## Li ion Rechargeable Battery High Power LED Tech Light

### SPECIFICATIONS

Light source	4 x XML LED
Light output	520 Lm (level I), 1300 Lm (level II) 2600 Lm (level III), 5200 Lm (level IV)
Casing material	Aluminum alloy. Anti-corrosive anodized
Power source	Li ion Rechargeable battery pack BATCELL18650x4
Angle of light beam	10° narrow beam
Color temperature	6500K
Burn time	2 hrs (level IV), 4 hrs (level III) 8 hrs (level II) and 20 hrs (level I)
Maximum depth	150 m tested
Size	Dia. 72 x L. 150.3mm
Weight in air	596 g (including battery)
Buoyancy in sea-water	-222 g (including battery)
Switching system	Push button with battery indicator
Front glass	Tempered optical glass
Lanyard	Included

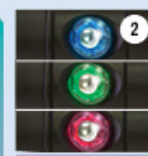
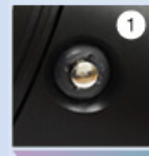



# TL3800<sup>P</sup> Supreme

3800 lumens

ERM  
EASY RELEASE MOUNT

Li ion Rechargeable Battery  
LED Tech Light

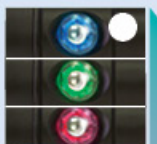

## SPECIFICATIONS

Light source	3 x XML LED
Light output	380 Lm (level I), 950 Lm (level II) 1900 Lm (level III), 3800 Lm (level IV)
Casing material	Aluminum alloy, Anti-corrosive anodized
Power source	Li ion Rechargeable battery pack BATCELL18650x4SUPREME
Angle of light beam	10° narrow beam
Color temperature	6500K
Burn time	3 hrs (level IV), 6 hrs (level III) 12 hrs (level II) and 30 hrs (level I)
Maximum depth	150 m tested
Size	Dia. 63 x L. 125 mm
Weight in air	517 g (including battery)
Buoyancy in seawater	-221 g (including battery)
Switching system	Push button with battery indicator
Front glass	Tempered optical glass
Lanyard	Included

1. 4 Levels of brightness and SOS controlled by a reliable push button design
2. Battery level indicator built-in: Blue color / Green color / Red color / Flash Red color
3. Ergonomic aluminum handle comes in a package
4. BATCELL18650x4 SUPREME Li ion Rechargeable Battery
5. Sturdy Goodman Glove for handy Tech-dive operation
6. Goodman handle with connector or Slim fit Goodman handle with connector. Sold separately.
7. Comes with random color outdoor dry bag

# TL3800<sup>P</sup>

3800 lumens

Rechargeable  
Light head

ERM  
EASY RELEASE MOUNT

Li ion Rechargeable Battery  
LED Tech Light

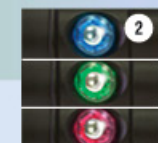

## SPECIFICATIONS

Light source	3 x XML LED
Light output	380 Lm (level I), 950 Lm (level II) 1900 Lm (level III), 3800 Lm (level IV)
Casing material	Aluminum alloy, Anti-corrosive anodized
Power source	Li ion Rechargeable battery pack 32650
Angle of light beam	10° narrow beam
Color temperature	6500K
Burn time	1.5 hrs (level IV), 3 hrs (level III) 6 hrs (level II) and 15 hrs (level I)
Maximum depth	150 m tested
Size	Dia. 63 x L. 135.6 mm
Weight in air	447 g (including battery)
Buoyancy in seawater	-217 g (including battery)
Switching system	Push button with battery indicator
Front glass	Tempered optical glass
Lanyard	Included

1. 4 Levels of brightness and SOS controlled by a reliable push button design
2. Battery level indicator built-in: Blue color / Green color / Red color / Flash Red color
3. Ergonomic aluminum handle comes in a package
4. BATCELL 32650 Li ion Rechargeable Battery
5. Sturdy Goodman Glove for handy Tech-dive operation
6. Goodman handle with connector or Slim fit Goodman handle with connector. Sold separately.
7. Comes with USB charger
8. Comes with random color outdoor dry bag



# TL2900P

2900 lumens



ERM EASY RELEASE MOUNT



Li ion Rechargeable Battery LED Tech Light



Available in 3 colors

## SPECIFICATIONS

Light source	3 x LED
Light output	290 Lm (level I), 725 Lm (level II) 1450 Lm (level III), 2900 Lm (level IV)
Casing material	Aluminum alloy. Anti-corrosive anodized
Power source	Li ion Rechargeable battery pack 32650
Angle of light beam	10° narrow beam
Color temperature	6500K
Burn time	1.5 hrs (level IV), 3 hrs (level III) 6 hrs (level II) and 15 hrs (level I)
Maximum depth	100 m tested
Size	Dia. 50 x L. 130 mm
Weight in air	359 g (including battery)
Buoyancy in seawater	-188 g (including battery)
Switching system	Push button with battery indicator
Front glass	Tempered optical glass
Lanyard	Included



- 4 Levels of brightness and SOS controlled by a reliable push button design
- Battery level indicator built-in: Blue color / Green color / Red color / Flash Red color
- Sturdy Goodman Glove for handy Tech-diver operation
- BATCELL 32650 Li ion Rechargeable Battery
- Ergonomic aluminum handle comes in a package
- Goodman handle with connector or Slim fit Goodman handle with connector. Sold separately.
- Comes with USB charger
- Comes with random color outdoor dry bag

# LIGHT HEAD





# AL2600 Black Molly V XWP II

2600 lumens



Available in 2 colors



## SPECIFICATIONS

Light source	4 x XML LED + 2 x XPE Red LED
Light output	260 Lm (level I), 650 Lm (level II) 1300 Lm (level III), 2600 Lm (level IV)
Light output (Red color mode)	150 Lm
Casing material	Aluminum alloy. Anti-corrosive anodized
Power source	Li ion Rechargeable battery pack 26650
Angle of light beam	120° wide beam
Color temperature	6500K
Burn time	2 hrs (level IV), 4 hrs (level III) 8 hrs (level II) and 20 hrs (level I)
Maximum depth	100 m tested
Size	Dia. 35.5 x L. 126.8 mm
Weight in air	218 g (including battery)
Buoyancy in seawater	-105 g (including battery)
Switching system	Push button with battery indicator
Front glass	Tempered optical glass
Lanyard	Included

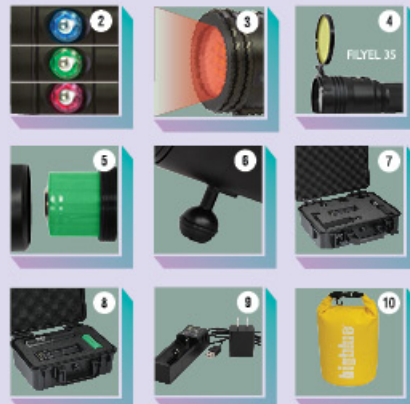

1. 4 Levels of brightness, 1 level of brightness of Red color mode and SOS controlled by a reliable push button design
2. Battery level indicator built-in: Blue color /Green color /Red color /Flash Red color
3. Built-in red color led enhances focusing performance
4. Removable yellow filter enhances warmer color tone
5. BATCELL26650 Li ion Rechargeable Battery
6. Comes with ball joint for easy system setup
7. Protective case for AL 2600XWP II and Single Arm Tray. Sold separately.
8. Protective case for AL 2600XWP II. Sold separately.
9. Comes with USB charger
10. Comes with random color outdoor dry bag

# AL1800 Black Molly IV XWP II Tri Color

1800 lumens



Available in 2 colors



## SPECIFICATIONS

Light source	4 x XML LED + 2 x XPE Red LED
Light output (Cool white mode)	450 Lm (level I), 900 Lm (level II) 1800 Lm (level III)
Light output (Warm white mode)	450 Lm (level I), 900 Lm (level II) 1800 Lm (level III)
Light output (Red color mode)	150 Lm
Casing material	Aluminum alloy. Anti-corrosive anodized
Power source	Li ion Rechargeable battery pack 26650
Angle of light beam	120° wide beam
Color temperature	6500K cool white and 5500K warm white
Burn time	2 hrs (level III), 4 hrs (level II) and 8 hrs (level I)
Maximum depth	100 m tested
Size	Dia. 35.5 x L. 126.8 mm
Weight in air	218 g (including battery)
Buoyancy in seawater	-105 g (including battery)
Switching system	Push button with battery indicator
Front glass	Tempered optical glass
Lanyard	Included



1. 3 Levels of brightness for cool white mode, 3 Levels of brightness for warm white mode, 1 level of brightness of Red color mode and SOS controlled by a reliable push button design
2. Battery level indicator built-in: Blue color /Green color /Red color /Flash Red color
3. Built-in red color led enhances focusing performance
4. Built in yellow color led enhances warmer color tone
5. BATCELL26650 Li ion Rechargeable Battery
6. Comes with ball joint for easy system setup
7. Protective case for AL 1800XWP Tri Color II and Single Arm Tray. Sold separately.
8. Protective case for AL 1800XWP Tri Color II. Sold separately.
9. Comes with USB charger
10. Comes with random color outdoor dry bag



# AL1800 NP II

1800 lumens



Li ion Rechargeable Battery Narrow Beam LED Light



Available in 2 colors

## SPECIFICATIONS

Light source	XML x LED
Light output	180 Lm (level I), 450 Lm (level II), 900 Lm (level III), 1800 Lm (level IV)
Casing material	Aluminum alloy. Anti-corrosive anodized
Power source	Li ion Rechargeable battery pack 26650
Angle of light beam	10° narrow beam
Color temperature	6500K
Burn time	1.5 hrs (level IV), 3 hrs (level III), 6 hrs (level II) and 15 hrs (level I)
Maximum depth	150 m tested
Size	Dia. 35.5 x L. 139.8 mm
Weight in air	235 g (including battery)
Buoyancy in seawater	-113 g (including battery)
Switching system	Push button with battery indicator
Front glass	Tempered optical glass
Lanyard	Included

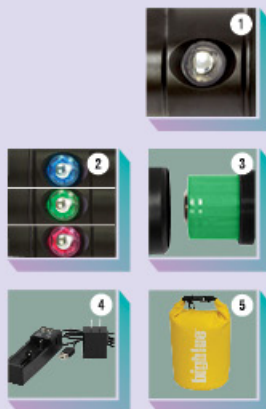

- 4 Levels of brightness and SOS controlled by a reliable push button design
- Battery level indicator built-in: Blue color / Green color / Red color / Flash Red color
- BATCELL26650 Li ion Rechargeable Battery
- Comes with USB charger
- Comes with random color outdoor dry bag

# AL1800 WP

1800 lumens



Li ion Rechargeable Battery Wide Beam LED Light



Available in 2 colors

## SPECIFICATIONS

Light source	XML x LED
Light output	180 Lm (level I), 450 Lm (level II), 900 Lm (level III), 1800 Lm (level IV)
Casing material	Aluminum alloy. Anti-corrosive anodized
Power source	Li ion Rechargeable battery pack 26650
Angle of light beam	85° wide beam
Color temperature	6500K
Burn time	1.5 hrs (level IV), 3 hrs (level III), 6 hrs (level II) and 15 hrs (level I)
Maximum depth	100 m tested
Size	Dia. 35.5 x L. 129 mm
Weight in air	228 g (including battery)
Buoyancy in seawater	-120 g (including battery)
Switching system	Push button with battery indicator
Front glass	Concave lens
Lanyard	Included

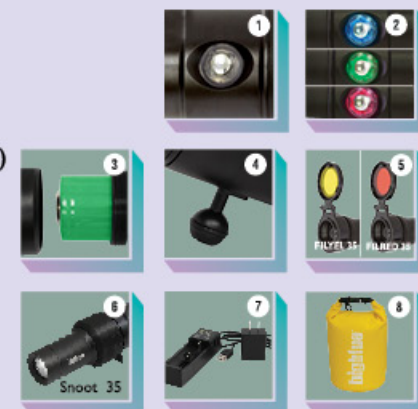

- 4 Levels of brightness and SOS controlled by a reliable push button design
- Battery level indicator built-in: Blue color / Green color / Red color / Flash Red color
- BATCELL26650 Li ion Rechargeable Battery
- Comes with ball joint for easy system setup
- Removable red and yellow filters enhances focusing performances and warm color tone
- Snoot Connector for AL1800WP. Sold separately.
- Comes with USB charger
- Comes with random color outdoor dry bag



# AL1300 Strobe

1300 lumens



Li ion Rechargeable Battery LED Strobe Light

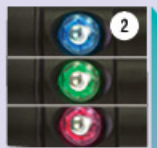

1. On / Off controlled by a reliable push button design
2. Battery level indicator built-in: Blue color / Green color / Red color / Flash Red color
3. BATCELL 18650 Li ion Rechargeable Battery
4. Comes with random color outdoor dry bag
5. Blinking frequency : 60 pulses per minute
6. Comes with USB charger

## SPECIFICATIONS

Light source	XML LED
Light output	1300 Lm
Blinking frequency	60 pulses per minute
Casing material	Aluminum alloy. Anti-corrosive anodized
Power source	Li ion Rechargeable battery pack 18650
Angle of light beam	270°
Burn time	12 hrs
Maximum depth	150 m tested
Size	Dia. 35.5 x L. 152.6 mm
Weight in air	170 g (including battery)
Buoyancy in seawater	-81 g (including battery)
Switching system	Push button with battery indicator
Lanyard	Included

# AL450 Strobe

450 lumens

LED Aluminium Strobe Light



## SPECIFICATIONS

Light source	Cree LED
Light output	450 Lm
Blinking frequency	60 pulses per minute
Casing material	Aluminum alloy. Anti-corrosive anodized
Power source	3 x AAA alkaline or Ni-MH batteries
Angle of light beam	270°
Burn time	36 hrs
Maximum depth	100 m tested
Size	Dia. 35.5 x L. 136.7 mm
Weight in air	131 g (including battery)
Buoyancy in seawater	-47 g (including battery)
Switching system	Push button
Lanyard	Included



1. Push on / off button on the bottom
2. 3xAAA stand-alone battery holder
3. Blinking frequency : 60 pulses per minute

# AL1300 NP Camouflage

1300 lumens

Slim Size

Li ion Rechargeable Battery  
Narrow Beam LED Light



Available in 4 colors

## SPECIFICATIONS

Light source	XML LED
Light output	130 Lm (level I), 325 Lm (level II) 650 Lm (level III), 1300 Lm (level IV)
Casing material	Aluminum alloy. Anti-corrosive anodized
Power source	Li ion Rechargeable battery pack 18650
Angle of light beam	10° narrow beam
Color temperature	6500K
Burn time	2 hrs (level IV), 5 hrs (level III) 10 hrs (level II) and 20 hrs (level I)
Maximum depth	150 m tested
Size	Dia. 33.2 x L. 139.8 mm
Weight in air	168 g (including battery)
Buoyancy in seawater	-76 g (including battery)
Switching system	Push button with battery indicator
Front glass	Tempered optical glass
Lanyard	Included



- 4 Levels of brightness and SOS controlled by a reliable push button design
- Battery level indicator built-in: Blue color / Green color / Red color / Flash Red color
- FILREDNP Red filter for AL1300NP. Sold separately.
- BATCELL 18650 Li ion Rechargeable Battery
- Our light can fit in glove or pouch. Sold separately.
- Comes with USB charger
- Comes with random color outdoor dry bag

# AL450 Camouflage

450 lumens

Narrow Beam Aluminum LED Light with  
Tail Switch Button



Available in 2 colors

## SPECIFICATIONS

- 450 Lumens Cree LED
- Size : Dia.33 x L.121.7mm
- Aluminum Alloy, anti-corrosive anodized
- 3xAAA alkaline or Ni-MH batteries
- Angle of light beam: 8°
- Up to 4hrs of burn time
- Lanyard included
- 150g ( including batteries) weight in air
- -70g ( including batteries) buoyancy in seawater
- Switching System : Push Button



1. Push on / off button on the bottom
2. 3xAAA stand-alone battery holder
3. AL 450NM Tail II LED with Glove
4. AL 450NM Tail II LED with Pouch
5. AL 450NM Tail II LED with Pouch and Glove



# AL450 Camouflage WM Tail

450 lumens

LED Aluminum Diving Light with Tail Switch Button



Available in 2 colors

### SPECIFICATIONS

- 450 Lumens Cree LED
- Size : Dia.36 x L.122.6mm
- Aluminum Alloy, anti-corrosive anodized
- 3xAAA alkaline or Ni-MH batteries
- Angle of light beam: 40°
- Up to 4hrs of burn time
- Lanyard included
- 160g ( including batteries) weight in air
- -74g ( including batteries) buoyancy in seawater
- Switching System : Push Button



1. Push on / off button on the bottom
2. 3xAAA stand-alone battery holder
3. AL 450WM Tail LED with Glove
4. AL 450WM Tail LED with Pouch
5. AL 450WM Tail LED with Pouch and Glove

# AL250 Camouflage

250 lumens

Multi-Function Aluminum LED Light



Available in 2 colors

### SPECIFICATIONS

Light source	1 x XPG LED
Light output	250 Lm
Casing material	Aluminum alloy, Anti-corrosive anodized
Power source	2xAA alkaline or Ni-MH batteries
Angle of light beam	8° narrow beam
Color temperature	6500K
Burn time	Up to 2 hrs
Maximum depth	100 m tested
Size	Dia. 28 x L. 147.8 mm
Weight in air	135 g (including battery)
Buoyancy in seawater	-85 g (including battery)
Front glass	Tempered optical glass
Lanyard	Included

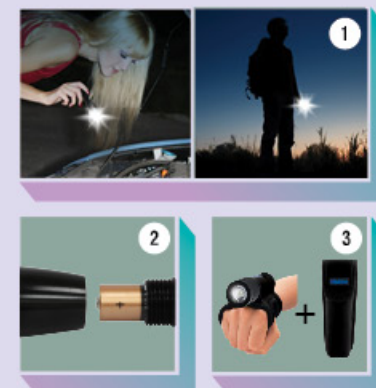

1. Light is suitable for multi-function
2. Operate with 2xAA batteries
3. Our light can fit in glove or pouch. Sold separately.



# AL1300 NP Tail

1300  
lumens

Slim  
Size

Li ion Rechargeable Battery Narrow Beam  
LED Light with Tail Switch Button



## SPECIFICATIONS

Light source	XML LED
Light output	130 Lm (level I), 325 Lm (level II) 650 Lm (level III), 1300 Lm (level IV)
Casing material	Aluminum alloy. Anti-corrosive anodized
Power source	Li ion Rechargeable battery pack 18650
Angle of light beam	10° narrow beam
Color temperature	6500K
Burn time	2 hrs (level IV), 5 hrs (level III) 10 hrs (level II) and 20 hrs (level I)
Maximum depth	150 m tested
Size	Dia. 33.2 x L. 152.2 mm
Weight in air	189 g (including battery)
Buoyancy in seawater	-87 g (including battery)
Switching system	Push button with battery indicator
Front glass	Tempered optical glass
Lanyard	Included



1. 4 Levels of brightness and SOS controlled by a reliable push button design
2. Battery level indicator built-in: Blue color / Green color / Red color / Flash Red color
3. FILREDNP Red filter for AL1300NP Tail. Sold separately.
4. BATCELL 18650 Li ion Rechargeable Battery
5. Our light can fit in glove or pouch. Sold separately.
6. Protective case for AL 1300NP Tail. Sold separately.
7. Comes with USB charger
8. Comes with random color outdoor dry bag

# AL1300 WP Tail

1300  
lumens

Slim  
Size

Li ion Rechargeable Battery Wide Beam  
LED Light with Tail Switch Button

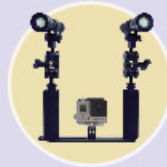

## SPECIFICATIONS

Light source	XML LED
Light output	130 Lm (level I), 325 Lm (level II) 650 Lm (level III), 1300 Lm (level IV)
Casing material	Aluminum alloy. Anti-corrosive anodized
Power source	Li ion Rechargeable battery pack 18650
Angle of light beam	85° wide beam
Color temperature	6500K
Burn time	2 hrs (level IV), 5 hrs (level III) 10 hrs (level II) and 20 hrs (level I)
Maximum depth	100 m tested
Size	Dia. 35.5 x L. 137.7 mm
Weight in air	177 g (including battery)
Buoyancy in seawater	-88 g (including battery)
Switching system	Push button with battery indicator
Front glass	Concave lens
Lanyard	Included



1. 4 Levels of brightness and SOS controlled by a reliable push button design
2. Battery level indicator built-in: Blue color / Green color / Red color / Flash Red color
3. Comes with the clip for easy system setup
4. Snoot Connector for AL1300WP Tail. Sold separately.
5. BATCELL 18650 Li ion Rechargeable Battery
6. Removable red and yellow filters enhances focusing performances and warm color tone
7. Our light can fit in glove or pouch. Sold separately.
8. Protective case for AL 1300WP Tail. Sold separately.
9. Comes with USB charger
10. Comes with random color outdoor dry bag



# AL1300 NP

1300 lumens



Slim Size

Li ion Rechargeable Battery Narrow Beam LED Light



## SPECIFICATIONS

Light source	XML LED
Light output	130 Lm (level I), 325 Lm (level II) 650 Lm (level III), 1300 Lm (level IV)
Casing material	Aluminum alloy. Anti-corrosive anodized
Power source	Li ion Rechargeable battery pack 18650
Angle of light beam	10° narrow beam
Color temperature	6500K
Burn time	2 hrs (level IV), 5 hrs (level III) 10 hrs (level II) and 20 hrs (level I)
Maximum depth	150 m tested
Size	Dia. 33.2 x L. 139.8 mm
Weight in air	168 g (including battery)
Buoyancy in seawater	-76 g (including battery)
Switching system	Push button with battery indicator
Front glass	Tempered optical glass
Lanyard	Included

1. 4 Levels of brightness and SOS controlled by a reliable push button design
2. Battery level indicator built-in: Blue color / Green color / Red color / Flash Red color
3. FILREDNP Red filter for AL1300NP. Sold separately.
4. BATCELL 18650 Li ion Rechargeable Battery
5. Our light can fit in glove or pouch. Sold separately.
6. Protective case for AL 1300NP. Sold separately.
7. Comes with USB charger
8. Comes with random color outdoor dry bag

# AL1300 WP

1300 lumens



Slim Size

Li ion Rechargeable Battery Wide Beam LED Light

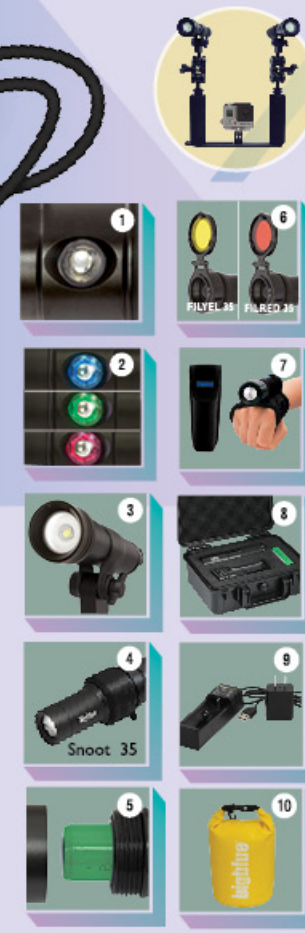

## SPECIFICATIONS

Light source	XML LED
Light output	130 Lm (level I), 325 Lm (level II) 650 Lm (level III), 1300 Lm (level IV)
Casing material	Aluminum alloy. Anti-corrosive anodized
Power source	Li ion Rechargeable battery pack 18650
Angle of light beam	85° wide beam
Color temperature	6500K
Burn time	2 hrs (level IV), 5 hrs (level III) 10 hrs (level II) and 20 hrs (level I)
Maximum depth	100 m tested
Size	Dia. 35.5 x L. 126.3 mm
Weight in air	162 g (including battery)
Buoyancy in seawater	-84 g (including battery)
Switching system	Push button with battery indicator
Front glass	Concave lens
Lanyard	Included

1. 4 Levels of brightness and SOS controlled by a reliable push button design
2. Battery level indicator built-in: Blue color / Green color / Red color / Flash Red color
3. Comes with the clip for easy system setup
4. Snoot Connector for AL1300WP. Sold separately.
5. BATCELL 18650 Li ion Rechargeable Battery
6. Removable red and yellow filters enhances focusing performances and warm color tone
7. Our light can fit in glove or pouch. Sold separately.
8. Protective case for AL 1300WP. Sold separately.
9. Comes with USB charger
10. Comes with random color outdoor dry bag



# AL1300 XWP

1300 lumens



Li ion Rechargeable Battery Extra Wide Beam LED Light

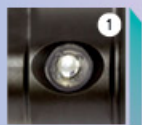

- 4 Levels of brightness and SOS controlled by a reliable push button design
- Battery level indicator built-in: Blue color / Green color / Red color / Flash Red color
- Comes with the clip for easy system setup
- Snoot Connector for AL1300XWP. Sold separately.
- BATCELL 18650 Li ion Rechargeable Battery
- Removable red and yellow filters enhances focusing performances and warm color tone
- Our light can fit in glove or pouch. Sold separately.
- Protective case for AL 1300XWP. Sold separately.
- Comes with USB charger
- Comes with random color outdoor dry bag

## SPECIFICATIONS

Light source	XML LED
Light output	130 Lm (level I), 325 Lm (level II) 650 Lm (level III), 1300 Lm (level IV)
Casing material	Aluminum alloy. Anti-corrosive anodized
Power source	Li ion Rechargeable battery pack 18650
Angle of light beam	120° wide beam
Color temperature	6500K
Burn time	2 hrs (level IV), 5 hrs (level III) 10 hrs (level II) and 20 hrs (level I)
Maximum depth	100 m tested
Size	Dia. 35.5 x L. 122.1 mm
Weight in air	160 g (including battery)
Buoyancy in seawater	-84 g (including battery)
Switching system	Push button with battery indicator
Front glass	Tempered optical glass
Lanyard	Included

# AL1200 RAFO

1200 lumens



Li ion Rechargeable Battery Wide Beam LED Light with Auto-Flash Off Function

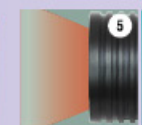

- 4 Levels of brightness, 1 level of brightness of Red Color mode and SOS controlled by a reliable push button design
- Battery level indicator built-in: Blue color / Green color / Red color / Flash Red color
- Comes with ball joint for easy system setup
- Automatic Flash Off Function AFO interval: 0.2 sec. +/- 0.1 sec.
- Built-in red color led enhances focusing performance
- BATCELL 18650 Li ion Rechargeable Battery
- Comes with USB charger
- Comes with random color outdoor dry bag

## SPECIFICATIONS

Light source	XML LED + 2 x XPE Red LED
Light output	120 Lm (level I), 300 Lm (level II) 600 Lm (level III), 1200 Lm (level IV) 150 Lm
Light output (Red color mode)	150 Lm
Casing material	Aluminum alloy. Anti-corrosive anodized
Power source	Li ion Rechargeable battery pack 18650
Angle of light beam	55° wide beam
Color temperature	6500K
AFO interval	0.2sec. +/- 0.1 sec.
Burn time	2 hrs (level IV), 5 hrs (level III) 10 hrs (level II) and 20 hrs (level I)
Maximum depth	100 m tested
Size	Dia. 42.4 x L. 128.3 mm
Weight in air	242 g (including battery)
Buoyancy in seawater	-129 g (including battery)
Switching system	Push button with battery indicator
Front glass	Tempered optical glass
Lanyard	Included



# AL450 WM TAIL 450 lumens

LED Aluminum Diving Light with Tail Switch Button



1. Push on / off button on the bottom
2. 3xAAA stand-alone battery holder
3. AL 450WM Tail LED with Glove
4. AL 450WM Tail LED with Pouch
5. AL 450WM Tail LED with Pouch and Glove

## SPECIFICATIONS

- 450 Lumens Cree LED
- Size : Dia.36 x L.122.6mm
- Aluminum Alloy, anti-corrosive anodized
- 3xAAA alkaline or Ni-MH batteries
- Angle of light beam: 40°
- Up to 4hrs of burn time
- Lanyard included
- 160g ( including batteries) weight in air
- -74g ( including batteries) buoyancy in seawater
- Switching System : Push Button

# AL450 NM Tail II Spotter 450 lumens

Narrow Beam Aluminum LED Light with Tail Switch Button

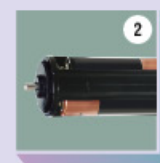

## SPECIFICATIONS

- 450 Lumens Cree LED
- Size : Dia.33 x L.121.7mm
- Aluminum Alloy, anti-corrosive anodized
- 3xAAA alkaline or Ni-MH batteries
- Angle of light beam: 8°
- Up to 4hrs of burn time
- Lanyard included
- 150g ( including batteries) weight in air
- -70g ( including batteries) buoyancy in seawater
- Switching System : Push Button

1. Push on / off button on the bottom
2. 3xAAA stand-alone battery holder
3. AL 450NM Tail II LED with Glove
4. AL 450NM Tail II LED with Pouch
5. AL 450NM Tail II LED with Pouch and Glove

# AL250

250  
lumens

Multi-Function Aluminum LED Light



## SPECIFICATIONS

Light source	1 x XPG LED
Light output	250 Lm
Casing material	Aluminum alloy. Anti-corrosive anodized
Power source	2xAA alkaline or Ni-MH batteries
Angle of light beam	8° narrow beam
Color temperature	6500K
Burn time	Up to 2 hrs
Maximum depth	100 m tested
Size	Dia. 28 x L. 147.8 mm
Weight in air	135 g (including battery)
Buoyancy in seawater	-85 g (including battery)
Front glass	Tempered optical glass
Lanyard	Included

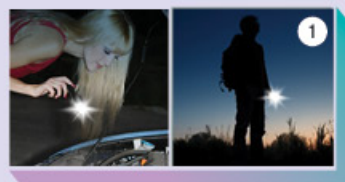

1. Light is suitable for multi-function
2. Operate with 2xAA batteries
3. Our light can fit in glove or pouch. Sold separately.
4. Available in 5 colors

# RGB White II

Changeable  
light head

Slim  
Size

4 Colors

Li ion Rechargeable Battery 4 Colors LED Light

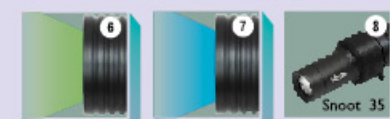
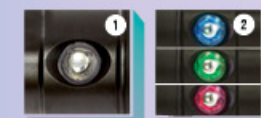

## SPECIFICATIONS

Light source	LED
Light output	500 Lm (white), 120 Lm (red) 40 Lm (blue), 300 Lm (green)
Casing material	Aluminum alloy. Anti-corrosive anodized
Power source	Li ion Rechargeable battery pack 18650
Angle of light beam	85° wide beam
Color temperature	6500K
Burn time	2 hrs
Maximum depth	100 m tested
Size	Dia. 35.5 x L. 126.3 mm
Weight in air	162 g (including battery)
Buoyancy in seawater	-84 g (including battery)
Switching system	Push button with battery indicator
Front glass	Concave lens
Lanyard	Included

1. 4 colors of light and SOS controlled by a reliable push button design
2. Battery level indicator built-in: Blue color / Green color / Red color / Flash Red color
3. Comes with the clip for easy system setup
4. BATCELL 18650 Li ion Rechargeable Battery
5. Built-in red color Led
6. Built-in green color Led
7. Built-in blue color Led
8. Snoot Connector for RGB White II. Sold separately.
9. Our light can fit in glove or pouch. Sold separately.
10. Comes with USB charger
11. Comes with random color outdoor dry bag



# CF1800 P

1800  
lumens

5X  
Focusable

Li ion Rechargeable Battery Changeable Focus  
LED Light



## SPECIFICATIONS

Light source	XML LED
Light output	180 Lm (level I), 450 Lm (level II) 900 Lm (level III), 1800 Lm (level IV)
Casing material	Aluminum alloy. Anti-corrosive anodized
Power source	Li ion Rechargeable battery pack 26650
Angle of light beam	7° narrow beam to 37° wide beam
Color temperature	6500K
Burn time	1.5 hrs (level IV), 3 hrs (level III) 6 hrs (level II) and 15 hrs (level I)
Maximum depth	100 m tested
Size	Dia. 35.5 x L. 169.3mm
Weight in air	301 g (including battery)
Buoyancy in seawater	-146 g (including battery)
Switching system	Push button with battery indicator
Front glass	Tempered optical glass
Lanyard	Included

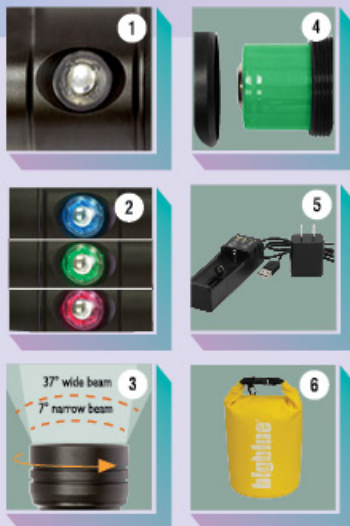

1. 4 Levels of brightness and SOS controlled by a reliable push button design
2. Battery level indicator built-in: Blue color / Green color / Red color / Flash Red color
3. Twist the front to change the focus (Turning force increases with depth)
4. BATCELL 26650 Li ion Rechargeable Battery
5. Comes with USB charger
6. Comes with random color outdoor dry bag

# CF1300 P

1300  
lumens

5X  
Focusable

Slim  
Size

Upgraded

Li ion Rechargeable Battery Changeable Focus  
LED Light



## SPECIFICATIONS

Light source	XML LED
Light output	130 Lm (level I), 325 Lm (level II) 650 Lm (level III), 1300 Lm (level IV)
Casing material	Aluminum alloy. Anti-corrosive anodized
Power source	Li ion Rechargeable battery pack 18650
Angle of light beam	7° narrow beam to 37° wide beam
Color temperature	6500K
Burn time	2 hrs (level IV), 5 hrs (level III) 10 hrs (level II) and 20 hrs (level I)
Maximum depth	100 m tested
Size	Dia. 35.5 x L. 169.3mm
Weight in air	245 g (including battery)
Buoyancy in seawater	-121 g (including battery)
Switching system	Push button with battery indicator
Front glass	Tempered optical glass
Lanyard	Included



1. 4 Levels of brightness and SOS controlled by a reliable push button design
2. Battery level indicator built-in: Blue color / Green color / Red color / Flash Red color
3. Twist the front to change the focus (Turning force increases with depth)
4. BATCELL 18650 Li ion Rechargeable Battery
5. Comes with USB charger
6. Comes with random color outdoor dry bag

# CF450 M

450  
lumens

5X  
Focusable

Slim  
Size

Changeable Focus LED Light



Available in 2 colors

## SPECIFICATIONS

Light source	Cree LED
Light output	450 Lm
Casing material	Aluminum alloy. Anti-corrosive anodized
Power source	3xAAA alkaline or Ni-MH batteries
Angle of light beam	7° to 37°adjustable
Color temperature	6500K
Burn time	Up to 4hrs
Maximum depth	100 m tested
Size	Dia. 35.5 x L. 121.5mm
Weight in air	193 g (including batteries)
Buoyancy in seawater	-81 g (including batteries)
Switching system	Magnetic Swivel
Front glass	Tempered optical glass & Convex Lens
Lanyard	Included



1. Twist the front to change the focus (Turning force increases with depth)
2. Magnetic Swivel Switch allows for one hand operation
3. 3xAAA stand-alone battery holder
4. CF 450 M LED with Glove
5. CF 450 M LED with Pouch
6. CF 450 M LED with Pouch and Glove

## EASY CLIP Rainbow Color Light



## SPECIFICATIONS

- Available fifteen color output –Red, Green, Orange, Blue, Purple, Yellow, Light Blue, Flash red, Flash green, Flash orange, Flash blue, Flash purple, Flash yellow, Flash light blue automatically run all fourteen modes.
- 12-24 hrs of burn time
- 2 x CR2032 batteries
- Dia. 32 x L. 38mm
- 100 meter tested
- Lanyard included
- 23g ( including batteries) weight in air
- -3g ( including batteries) buoyancy in seawater

## EASY CLIP Light with Flash



## SPECIFICATIONS

- Available six color output – Blue, Red, Green, Flash Blue, Flash Red, Flash Green
- Up to 36 hrs of burn time
- 2 x CR2032 batteries
- Dia. 32 x L. 38mm
- 100 meter tested
- Lanyard included
- 23g ( including batteries) weight in air
- -3g ( including batteries) buoyancy in seawater



# HL1000<sub>N</sub>

1000 lumens

## SPECIFICATIONS

Li ion Rechargeable Battery  
Narrow Beam LED Head Light



FILREDHLN Red filter for HL 1000N. Sold separately.



Light source	Cree LED
Light output	100 Lm (level I), 250 Lm (level II) 500 Lm (level III), 1000 Lm (level IV)
Casing material	Aluminum alloy light head and Polycarbonate body
Power source	Li ion Rechargeable battery pack BATCELL18650
Angle of light beam	8° narrow beam
Color temperature	6500K
Burn time	2 hrs (level IV), 4 hrs (level III) 8 hrs (level II) and 20 hrs (level I)
Maximum depth	100 m tested
Size	Dia. 36.8 x L. 84.4 mm with light head dia. 41 mm
Weight in air	205 g (including battery)
Buoyancy in seawater	-74 g (including battery)
Switching system	Push button with battery indicator
Front glass	Tempered optical glass



4 levels of brightness and SOS controlled by a reliable push button design



BATCELL18650 Li ion Rechargeable Battery



Battery level indicator built-in: Blue color / Green color / Red color / Flash Red color

# HL450<sub>N</sub>

450 lumens

## SPECIFICATIONS

Narrow Beam LED  
Head Light



FILREDHLN Red filter for HL 450N. Sold separately.



Light source	Cree LED
Light output	45 Lm (level I), 113 Lm (level II) 225 Lm (level III), 450 Lm (level IV)
Casing material	Aluminum alloy light head and Polycarbonate body
Power source	3 x AAA alkaline batteries
Angle of light beam	8° narrow beam
Color temperature	6500K
Burn time	2 hrs (level IV), 4 hrs (level III) 8 hrs (level II) and 20 hrs (level I)
Maximum depth	100 m tested
Size	Dia. 36.8 x L. 84.4 mm with light head dia. 41 mm
Weight in air	187 g (including batteries)
Buoyancy in seawater	-56 g (including batteries)
Switching system	Push button with battery indicator
Front glass	Tempered optical glass



4 levels of brightness and SOS controlled by a reliable push button design



3 x AAA alkaline batteries



Battery level indicator built-in: Blue color / Green color / Red color / Flash Red color

# HL1000<sub>xw</sub>

1000 lumens



## SPECIFICATIONS

Li ion Rechargeable Battery  
Extra Wide Beam LED Head Light



Built-in red color led enhances focusing performance

Light source	2 x Cree LED + 2 x XPE Red LED
Light output	100 Lm (level I), 250 Lm (level II) 500 Lm (level III), 1000 Lm (level IV)
Light output (Red color mode)	150 Lm
Casing material	Aluminum alloy light head and Polycarbonate body
Power source	Li ion Rechargeable battery pack BATCELL18650
Angle of light beam	120° wide beam
Color temperature	6500K
Burn time	2 hrs (level IV), 4 hrs (level III) 8 hrs (level II) and 20 hrs (level I)
Maximum depth	100 m tested
Size	Dia. 36.8 x L. 84.4 mm with light head dia. 38.8mm
Weight in air	207 g (including battery)
Buoyancy in seawater	-76 g (including battery)
Switching system	Push button with battery indicator
Front glass	Tempered optical glass



# HL450<sub>xw</sub>

450 lumens



## SPECIFICATIONS

Extra Wide Beam LED  
Head Light



Built-in red color led enhances focusing performance

Light source	2 x Cree LED + 2 x XPE Red LED
Light output	45 Lm (level I), 113 Lm (level II) 225 Lm (level III), 450 Lm (level IV)
Light output (Red color mode)	100 Lm
Casing material	Aluminum alloy light head and Polycarbonate body
Power source	3 x AAA alkaline batteries
Angle of light beam	120° wide beam
Color temperature	6500K
Burn time	2 hrs (level IV), 4 hrs (level III) 8 hrs (level II) and 20 hrs (level I)
Maximum depth	100 m tested
Size	Dia. 36.8 x L. 84.4 mm with light head dia. 38.8 mm
Weight in air	189 g (including batteries)
Buoyancy in seawater	-58 g (including batteries)
Switching system	Push button with battery indicator
Front glass	Tempered optical glass





# Green Spot light & Red Spot light

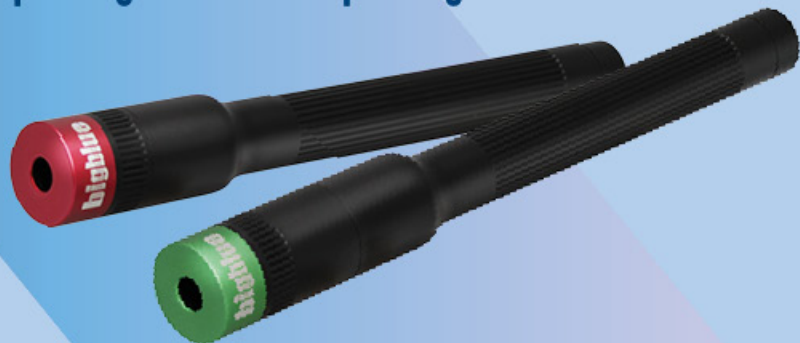

## SPECIFICATIONS

### GREEN SPOT LIGHT

### RED SPOT LIGHT

Light source : Green Laser  
 Light output : Below 1 mW  
 Casing material : Aluminum alloy.  
 Anti-corrosive anodized  
 Power source : 2 x AAA alkaline or Ni-MH batteries  
 Wavelength : 520nm  
 Burn time : Up to 12 hrs  
 Maximum depth : 100 m tested  
 Size : Dia. 19 x L. 168.6 mm  
 Weight in air : 89 g (including batteries)  
 Buoyancy in seawater : -54 g (including batteries)  
 Switching system : Twisting Bezel  
 Front glass : Tempered optical glass  
 Lanyard : Included

Red Laser  
 Below 1 mW  
 Aluminum alloy.  
 Anti-corrosive anodized  
 Power source : 2 x AAA alkaline or Ni-MH batteries  
 Wavelength : 650nm  
 Burn time : Up to 12 hrs  
 Maximum depth : 100 m tested  
 Size : Dia. 19 x L. 154.1 mm  
 Weight in air : 82 g (including batteries)  
 Buoyancy in seawater : -51 g (including batteries)  
 Switching system : Twisting Bezel  
 Front glass : Tempered optical glass  
 Lanyard : Included



Operate with 2 x AAA batteries



CLIPMNTSPOT Mounting clip for Green Spot Light and Red Spot Light. Sold seperately.

# Protective Case Series



Model :	PC101A	PC102A	PC103A	PC104A	PC105A	PC106A
Outer Dimension :	225 x 180 x 100 mm	350 x 270 x 120 mm	340 x 310 x 120 mm	360 x 285 x 190 mm	420 x 360 x 130 mm	420 x 360 x 190 mm
Inner Dimension :	200 x 135 x 85 mm	325 x 210 x 110 mm	310 x 250 x 107 mm	330 x 270 x 175 mm	380 x 310 x 120 mm	380 x 310 x 180 mm

# FLUORODIVE Kit sets

Science has discovered corals contain Fluorescent Proteins invisible to the naked eye that jump into view using innovative high-intensity fluorolights and filters.

Bigblue Fluorodive Kits provide everything you need to experience this incredibly beautiful effect. You get specially designed filters to precisely match the coral fluorescence wavelength, and yellow blue-barrier filters to increase the intensity of the colors emitted by the corals. Our innovative design is the only one that allows you to easily switch between blue and white light to accommodate changes in dive conditions.

These kits are suitable for night divers, resorts, science institutions, ecological monitoring groups and specialty photographers. Truly there is nothing that can match the beauty of witnessing coral fluorescence on your next night dive!



Photos of the fluorescence stimulated by the specific wavelength and captured through a barrier filter

<b>FDKNP33</b>	AL130NP / AL1300NP Tail Fluorodive Kit <span style="float: right;"><b>NEW</b></span>
<b>FDK35</b>	CF450M / CF1300P / AL1300WP / AL1300XWP / AL1300WP Tail / AL1800WP / CF1800P / BLACK MOLLY IV / BLACK MOLLY V / Fluorodive Kit
<b>FDK38</b>	CF450 / CF1200P / AL1200WP / AL1200XWP / AL1200WP Tail /BLACK MOLLY II / BLACK MOLLY III Fluorodive Kit
<b>FDK44</b>	VL4600P / VTL2900P Fluorodive Kit
<b>FDK55</b>	VTL4200P / VL11000P / VL9000P Tri Color Fluorodive Kit
<b>FDK63</b>	CB7200P / CB11000P / VTL9000P VTL9000P Max / VTL11000P / Fluorodive Kit



# Camera Filters

Camera filters are available for you to capture the macro or wide angle photos or videos of the memorable aquatic creatures.

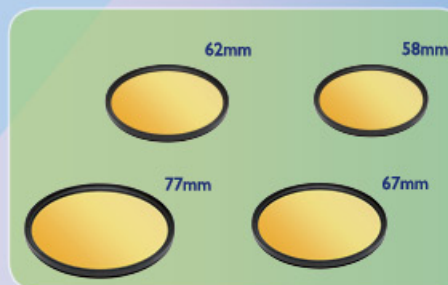

# FILFLUOR015000

Fluorodive filter for VL 18000P Pro Mini / VL 18000P Pro Mini Tri Color / CB16500P





# COMBO PACK SERIES

**AL 450 NM Tail II Spotter**  
Narrow Beam Aluminum LED Light with Tail Switch Button

**AL 1800NP II**  
Li Ion Rechargeable Battery Narrow Beam LED Light

**Easy Clip**  
Rainbow Color light



**AL 250**  
Multi-Function Aluminum LED Light

**AL 1800NP II**  
Li Ion Rechargeable Battery Narrow Beam LED Light

**Easy Clip**  
Rainbow Color light



**AL 450 NM Tail II Spotter**  
Narrow Beam Aluminum LED Light with Tail Switch Button

**AL 1300NP**  
Li Ion Rechargeable Battery Narrow Beam LED Light

**Easy Clip**  
Rainbow Color light



**AL 450 WM Tail**  
LED Aluminum Diving Light with Tail Switch Button

**AL 1300NP**  
Li Ion Rechargeable Battery Narrow Beam LED Light

**Easy Clip**  
Rainbow Color light





# COMBO PACK SERIES

**AL 450 NM Tail II Spotter**  
Narrow Beam Aluminum LED Light with Tail Switch Button

**AL 1300WP**  
Li ion Rechargeable Battery Wide Beam LED Light

**Easy Clip**  
Rainbow Color light



**AL 450 WM Tail**  
LED Aluminum Diving Light with Tail Switch Button

**AL 1300WP**  
Li ion Rechargeable Battery Wide Beam LED Light

**Easy Clip**  
Rainbow Color light



**AL 250**  
Multi-Function Aluminum LED Light

**AL 1300NP**  
Li ion Rechargeable Battery Narrow Beam LED Light

**Easy Clip**  
Rainbow Color light



**AL 250**  
Multi-Function Aluminum LED Light

**AL 1300WP**  
Li ion Rechargeable Battery Wide Beam LED Light

**Easy Clip**  
Rainbow Color light





# CAMERA TRAY 34



Camera Tray 34 with 34cm long tray. Two 1" Ball joint arms with no-slip grip. Compatible with Smart Phone Housings e.g. Iphone, Samsung, Huawei

# CAMERA TRAY 27



Camera Tray 27 with 27cm long tray. Two 1" Ball joint arms with no-slip grip. Compatible with Olympus TG4/TG5 Housings.

# BBGPTray

Go Pro Tray



Go Pro Hot Shoe Adapter



Go Pro Light Adaptor



# Go Pro Kit sets

## GP4200 Kit

- 1 pc. of Double Clip (CLP02)
- 1 pc. of Go Pro Tray (BBGPTRAY)
- Light not included



## GP1300 Kit

- 2 pcs. of Double Clip (CLP02)
- 2 pcs. of Sea & Sea Standard (DA009)
- 1 pc. of Go Pro Tray (BBGPTRAY)
- Lights not included



## GP450 Kit

- 2 pcs. of Mounting Clip (CLIPMINTCF)
- 2 pcs. of Double Clip (CLP02)
- 2 pcs. of Sea & Sea Standard (DA009)
- 1 pc. of Go Pro Tray (BBGPTRAY)
- Lights not included



## Protective Case for Go Pro Tray Kit Set

- 1 pc. of ALI300WVP
- 1 pc. of ALI300XVP
- 2 pcs. of Double Clip (CLP02)
- 2 pcs. of Sea & Sea Standard (DA009)
- 1 pc. of Go Pro Tray (BBGPTRAY)



# EXTENDGPTRAY

Extendable Go Pro Tray

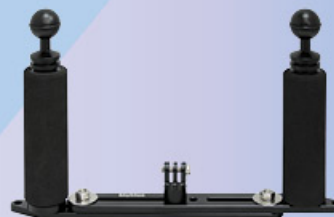

Extend from 176mm to 287mm

# SINGLEARMTRAY

Single Arm Go Pro Tray



# FLEXICAMERATRAY 27

7" Flexi Arm Camera Tray 27



# FLEXICAMERATRAY 34

7" Flexi Arm Camera Tray 34



# FLEXIGPTRAY

7" Flexi Arm Go Pro Tray



# FLEXISINGLEARMTRAY

7" Flexi Arm Single Arm Tray



# FLEXIEXTENDGPTRAY

7" Flexi Arm Extendable Go Pro Tray



# TRIPOD PLATE



Size:W.112 x L.272mm  
Comes with four 1" Ball joint



Easy assemble with double clip and arms.  
Double clip and arms sold separately.

# Batteries & Chargers



**BATCELL I8650**

Battery for ALI300NP / ALI300WP / ALI300XWP / ALI300NP Tall / ALI300WP Tall / CF1300P / ALI200RAFO / HL1000XW / HL1000N / RGB White II / ALI200NP IR / ALI200VWP IR / ALI300 Strobe



**BATCELL 26650**

Battery for Black Molly IV / Black Molly V / Black Molly VB / ALI800NP II / ALI800WP / CF1800P

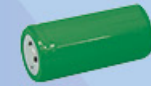

**BATCELL 32650**

Battery for VL4600P / VTL4200P / TL3800P / VTL2900P / TL2900P / VL4600PB / VTL4200PB / VTL2900PB



**CR2032**

Battery for Easy Clip Light / Controller



**BATCELL I8650x3**

Battery for CB 4000P / VL6200P

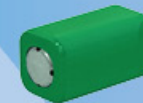

**BATCELL I8650x4**

Battery for VLI1000P / VTL9000P / VTL9000P Max / TLS200P / VL9000P Tri Color / VTL1000P / VLI1000PBRC

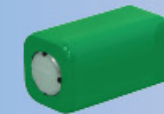

**BATCELL 21700x4**

Battery for CB7200P / CB11000P / CB7200PB / CB11000PBRC

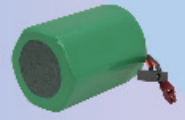

**BATCELL I8650x7**

Battery for VLI8000P Pro Mini / VLI8000P Pro Mini Tri Color / CB16500P / TL8000P / VLI8000PBRC / CB16500PBRC

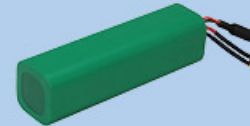

**BATCELL CANISTER**

Battery for TLS200P Backmount / Sidemount / VTL9000P Backmount / Sidemount



**BATCELL I8650x4 SUPREME**

Battery for TL3800P Supreme

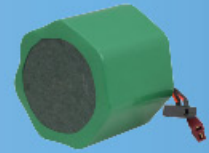

**BATCELL 21700x8**

Battery for VL36000P / CB30000P II / VL36000PBRC



**BATCELL 60000**

Battery for VL65000P / CB60000P



**BATCHR 60000**

Charger for VL65000P / CB60000P



**BATCHR 21700x8**

Charger for VL36000P / CB30000P II / VL36000PBRC



**BATCHR I8650x7**

Charger for VLI8000P Pro Mini / VLI8000P Pro Mini Tri Color / CB16500P / TL8000P / VLI8000PBRC / CB16500PBRC





**BATCHR21700x4**

Charger for CB7200P /  
CBI1000P /CB7200PB /  
CBI1000PBRC



**BATCHR18650x3**

Charger for CB4000P /  
VL6200P



**BATCHR18650x4**

Charger for VLI1000P /  
VTL9000P /TL5200P / VL9000P  
Tri Color /VTL9000P Max /  
VLI1000PBRC /VTLI1000P



**BATCHR18650x4 SUPREME**

Charger for TL3800P Supreme



**BATCHRCANISTER**

Charger for  
TL5200P Backmount / Sidemount  
VTL9000P Backmount / Sidemount



**BATCHRUSB**

Charger for  
AL1300NP / AL1300WP / AL1300XWP /  
AL1300NP Tail / AL1300WP Tail / CF1300P /  
AL1200AFO / HL1000XW / HL1000N /  
RGB White II / AL1200NPIR /  
AL1200VPIR / AL1300 Strobe /  
Black Molly IV / Black Molly V /  
Black Molly VB / VTL2900P / TL2900P /  
VTL2900PB / VTL4200PB / VTL4200P /  
VL4600P /VL4600PB /TL3800P / AL1800NP II /  
AL1800WP / CF1800P / BATCELL18650 /  
BATCELL26650 / BATCELL32650

# Accessories



**AF 55**

Ambient filter for  
VLI1000P /VLI1000PBRC /  
VL9000P Tri Color  
For 10-15 meter depth



**AF 63**

Ambient filter for  
CB7200P / CB7200PB /  
CBI1000P /  
CBI1000PBRC /  
VTL9000P / VTL9000P Max /  
VTLI1000P  
For 10-15 meter depth



**AF 70**

Ambient filter for  
VL18000P Pro Mini /  
VL18000P Pro Mini Tri Color /  
VL18000PBRC / CBI6500P /  
CBI6500PBRC  
For 10-15 meter depth



**AF 85**

Ambient filter for  
VL36000P / VL36000PBRC /  
CB30000P II  
For 10-15 meter depth



**AF 55-LB**

Ambient filter for  
VLI1000P /VLI1000PBRC /  
VL9000P Tri Color  
For 5-10 meter depth



**AF 63-LB**

Ambient filter for  
CB7200P / CB7200PB /  
CBI1000P /  
CBI1000PBRC /  
VTL9000P / VTL9000P Max /  
VTLI1000P  
For 5-10 meter depth



**AF 70-LB**

Ambient filter for  
VL18000P Pro Mini /  
VL18000P Pro Mini Tri Color /  
VL18000PBRC / CBI6500P /  
CBI6500PBRC  
For 5-10 meter depth



**AF 85-LB**

Ambient filter for  
VL36000P / VL36000PBRC /  
CB30000P II  
For 5-10 meter depth

## CONTROLLER

Remote Control for VL36000PBRC /  
VL18000PBRC / CBI6500PBRC /  
VLI1000PBRC / CBI1000PBRC



## 2M OPTICAL FIBRE

2 Meters Optical fibre for VL36000PBRC /  
VL18000PBRC / CBI6500PBRC /  
VLI1000PBRC / CBI1000PBRC



## OPTICAL FIBRE

1 Meter Optical fibre for VL36000PBRC /  
VL18000PBRC / CBI6500PBRC /  
VLI1000PBRC / CBI1000PBRC



**TLGGLOVE**

Goodman glove for any light with a  
two-prong mounting square



**NPGGLOVE**

Neoprene glove for Mini Light



**NPGGLOVE**

Neoprene glove for  
AL1300NP / AL1300WP /  
AL1300XWP / AL1300NP Tail /  
AL1300WP Tail / AL1200NP IR /  
AL1200WP IR



**PISTOLGRIPHANDLE**

Pistol Grip Handle for any light with  
a two-prong mounting square

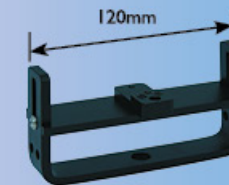

**GHA-01C**

Goodman handle with connector for  
any light with a two-prong mounting  
square

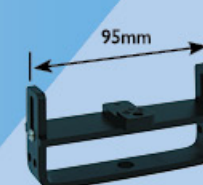

**SFGHA-01C**

Slim Fit Goodman handle with connector  
for any light with a two-prong mounting  
square

# Accessories



**LNTHANDLE**

Lantern style handle



**FILFLUORO I 5000**

Fluorodive filter for CB16500P / VL18000P Pro Mini / VL18000P Pro Mini Tri Color



**FDMASKYL**

Yellow filter for Fluorodiving



**YELLOW PLATE**

Yellow plate for Fluorodiving



**SNOOT 35**

Snoot Connector for ALI300WP / ALI300XWP / ALI300WP Tail / RGB White II / ALI800WP



**SNOOT 38**

Snoot Connector for ALI200WP / ALI200XWP / ALI200WP Tail / RGB White



**SNOOT 50**

Snoot Connector for CB 4000P



**SNOOT 55**

Snoot Connector for VL6000P



**SNOOT 63**

Snoot Connector for CB7200P / CB11000P / CB7200PB / CB11000PBR



**FILRED35**

Red filter for ALI300WP / ALI300XWP / ALI300WP Tail / ALI800WP



**FILREDSM**

Red filter for ALI200WP / ALI200XWP / ALI200WP Tail



**FILRED63**

Red filter for VTL11000P



**FILREDNP**

Red filter for ALI300NP / ALI300NP Tail



**FILREDHLN**

Red filter for HL1000N / HL450N



**FILYELLG**

Yellow filter for VTL4200P / VLI1000P / VTL4200PB / VLI1000PBR



**FILYEL35**

Yellow filter for ALI300WP / ALI300XWP / ALI300WP Tail / Black Molly V / Black Molly VB / ALI800WP



**FILYEL44**

Yellow filter for VL4600P / VL4600PB / VTL2900P / VTL2900PB



**FILYEL63**

Yellow filter for VTL9000P / VTL9000P Backmount / Sidemount / VTL9000P Max / VTL11000P



**FILYELSM**

Yellow filter for ALI200WP / ALI200XWP / ALI200WP Tail / Black Molly III



**CLIPMNTSPOT**

Mounting clip for Green Spot Light / Red Spot Light



**CLIPMNTAL**

Mounting clip for ALI300WP / ALI300XWP / CF1300P / ALI200WP IR



**CLIPMNTCF**

Mounting clip for CF450M / AL450VWM Tail / ALI300WP Tail



**GO PRO MOUNT**

Go Pro Mount for Go Pro Camera



**1" BALL JOINT**

1" Ball Joint fit for any light with a two-prong mounting square



**SPRING CORD**

Length : 330mm



**EASY RELEASE MOUNT**

Easy Release Mount fit for helmet / DPV



**NPHOODMS**

Neoprene hood for one light holster



**NPHOODMD**

Neoprene hood for two light holster



**NPRPOUCH**

Neoprene pouch with retractor for ALI300NP / ALI300VWP / ALI300XWP / ALI300NP Tail / ALI300WP Tail / ALI200NPIR / ALI200WPIR



**NPRPOUCHM**

Neoprene pouch with retractor for Mini Light



# Accessories

## Outdoor Dry Bags



3L	5L	7L	15L	20L
Dia. 140 x L. 330 mm	Dia. 170 x L. 380 mm	Dia. 180 x L. 510 mm	Dia. 240 x L. 540 mm	Dia. 240 x L. 600 mm
Available in 5 colors Yellow, Green, Pink, Light Blue, Blue	Available in 5 colors Yellow, Green, Pink, Light Blue, Blue	Available in 6 colors Yellow, Green, Pink, Light Blue, Blue, Black	Available in 5 colors Yellow, Green, Blue, Black, Orange	Available in 5 colors Yellow, Green, Blue, Black, Orange

# Easy Release Mount Series



Easy Release Glove



Easy Release Goodman Handle



Easy Release GoPro Mount Glove



Easy Release Slim Fit Goodman Handle

# Photo/Video Arms & Accessories

## Float Arms Series

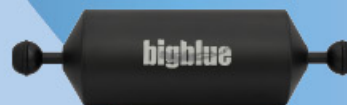

9" Float Arm

Dia. 70 x 228mm  
Weight above water : 281g  
Buoyancy lift : 360g

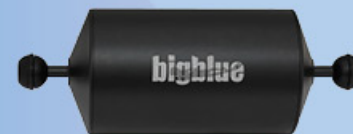

9" Jumbo Float Arm

Dia. 90 x 228mm  
Weight above water : 349g  
Buoyancy lift : 697g

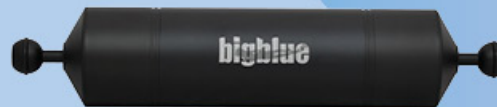

13" Float Arm

Dia. 70 x 330mm  
Weight above water : 430g  
Buoyancy lift : 612g

## Flexi Arms Series



7" Flexi Arm



9" Flexi Arm



6" Flexi Arm Hot Shoe YS Adapter



6" Flexi Arm Hot Shoe Ball Adapter



YS Adapter

# Photo/Video Arms & Accessories

## Clips

- Made of T6061 grade aluminum
- Available in 3 versions: long double clip, double clip and a triple clip
- Ergonomic handle makes it easy to twist on and off



Long CLP02 Double clip

Length : 80mm



CLP 02 Double clip

Length : 63mm



CLP 03 Triple clip

## Arms

- Full T6061 grade aluminum
- Available in 4 lengths: 5", 8", 12", 16"



5" Arm



8" Arm



12" Arm



16" Arm

For 1" ball joint to connect to extend the connection



# DA Series



DA001

Hot Shoe Adapter



DA002

Sea & Sea Adapter



DA003

Light & Motion Adapter



DA004

Standard Dovetail Plate



DA005

8mm Thread



DA006

Sea & Sea Light Adapter



DA007

Sea & Sea Hot Shoe Adapter



DA008

Sea & Sea Medium



DA009

Sea & Sea Standard



DA010

Base Plate Ball Mount



DA011

T-Groove Adapter



DA012

Universal Mount Base



DA013F

1/4" Thread Adapter



DA013M

1/4" Thread Adapter



DA014

Ikelite 200 Strobe Adapter



DA015

Single Ball Arm with Sea & Sea Adapter



DA016

UK Light Adapter



DA017

Standard Dovetail



DA018

Inon Z Series Strobe Adapter



DA022

Slot Stay



DA023

6mm Thread Adapter

Specifications subject to change without prior notice.





# highblue®

## Lifestyle

OUTDOOR ADVENTURE GEAR



30L Backpack  
Camouflage

Size : Dia. 270 x L.670 mm  
Available in 3 colors  
Camo Blue, Camo Brown,  
Camo Green



3L Outdoor Dry Bag  
Camouflage

Size: Dia. 140 x L.330 mm  
Available in 3 colors  
Camo Blue, Camo Brown,  
Camo Green



Sport Water Bottle  
Camouflage

Size: Dia. 80 x L.273 mm  
Volume: 800mL (27 oz)  
Weight : 360g  
Available in 2 colors  
Camo Blue, Camo Pink



# Our Distributors & Dealers



**Aruba / Bonaire / Curacao Distributor :**  
**Palm Trading Bonaire NV**  
Contact Person : Joyce Sonneveld  
E-mail : sales@palmtradingnv.com  
Phone : 599 717 2072  
Mail : Hanchi Amboina 5, Kralendijk  
Bonaire Dutch Caribbean



**Australia Distributor : Adreno**  
Contact Person : Clive Lewis  
E-mail : clive@adreno.com.au  
Phone : 61-07-3391-2299  
Mail : 54-58 Deshon Street, Woolloongabba,  
Brisbane, QLD 4102, Australia



**Austria Distributor :**  
**Custom Diving Systems**  
Contact Person : Yannig Charles  
E-mail : contact@cds-pro.com  
Phone : +33 0 6 114 81 114  
Mail : 563, Rue De La Prairie 73350  
Bozel , France



**Belgium/ Netherlands / Luxembourg  
Distributor : Custom Diving Systems**  
Contact Person : Yannig Charles  
E-mail : contact@cds-pro.com  
Phone : +33 0 6 114 81 114  
Mail : 563, Rue De La Prairie 73350  
Bozel , France



**Brazil Distributor : Seasub**  
Contact Person : Pablo Y. Varela  
E-mail : pablo@seasub.com.br  
Phone : 55-11-38328342  
Mail : Rua Baumann, 1039/1051,  
Cep 05318000,  
Sao Paulo, Brazil



**Canada Distributor :**  
**Pacific Scuba Industries**  
Contact Person : Michael Joseph &  
Laura Valente  
E-mail : laurabigblue@outlook.com  
Phone : 778-834-0184  
Mail : Unit A11-33733 King Road  
Abbotsford, BC,  
V2S 7M9, Canada



**Czech Republic Distributor :**  
**Custom Diving Systems**  
Contact Person : Yannig Charles  
E-mail : contact@cds-pro.com  
Phone : +33 (0) 6 114 81 114  
Mail : 563, Rue De La Prairie 73350  
Bozel , France



**France / Europe Distributor :**  
**Custom Diving Systems**  
Contact Person : Yannig Charles  
E-mail : contact@cds-pro.com  
Phone : +33 (0) 6 114 81 114  
Mail : 563, Rue De La Prairie 73350  
Bozel , France



**Germany Distributor :**  
**Custom Diving Systems**  
Contact Person : Yannig Charles  
E-mail : contact@cds-pro.com  
Phone : +33 (0) 6 114 81 114  
Mail : 563, Rue De La Prairie 73350  
Bozel , France



**Greece / Croatia Distributor :**  
**Custom Diving Systems**  
Contact Person : Yannig Charles  
E-mail : contact@cds-pro.com  
Phone : +33 (0) 6 114 81 114  
Mail : 563, Rue De La Prairie 73350  
Bozel , France



**Indonesia Distributor : Divesea Indonesia**  
Contact Person : Chatra Hapsoro  
E-mail : bigblue.id@gmail.com  
Phone : 62-82145490450  
Mail : Metro Park Residence, Unit MA-LG-05,  
JL. Pilar Mas Utama Raya Kav 28,  
Kebon Jeruk, Jakarta Barat 11520 Indonesia



**Italy/ Malta Distributor :**  
**Custom Diving Systems**  
Contact Person : Yannig Charles  
E-mail : contact@cds-pro.com  
Phone : +33 (0) 6 114 81 114  
Mail : 563, Rue De La Prairie 73350  
Bozel , France



**Japan Distributor : Zero Co., Ltd.**  
Contact Person : Katsuhiko Saotome  
E-mail : zero@zero-zero.co.jp  
Phone : 81-3-5721-1906  
Fax: 81-3-5721-1910  
Mail : 1-11-5 Takaban, Meguro-Ku,  
Tokyo, Japan



**Korea Distributor : King Sports**  
Contact Person : Mr. Chang / Yun Hee Chang  
E-mail : kingdive@kingsports.co.kr  
Phone : 82-2-3628251  
Mail : 35-4, 1GA, Manri-Dong, Chung-Gu,  
Seoul, Korea



**Kuwait Dealer : Ilmunz Marine Co.**  
Contact Person : Abdulrahman Al-Serheed  
E-mail : ilmunz@ilmunz.com  
Phone : +965 95500969  
Mail : Creative Design Center , Block 1 , Street 10,  
Building 63, Store 2.2,  
Shuwaikh Industrial 1, Kuwait



**Malaysia Distributor :**  
**Rainbow Runner Sdn Bhd**  
Contact Person : Sim  
E-mail : ops@rainbowrunner.net  
Phone : 60-341-622837  
Fax: 60-341-617837  
Mail : 5, Ukay Boulevard, Jalan Lingkaran  
Tengah 2,Hulu Kelang, 68000 Ampang,  
Selangor, Malaysia



**Maldives Dealer : Sea Gear**  
Contact Person : Hussien Abdulla  
E-mail : sales@seagear.com.mv  
Phone : +960 3302737  
Mail : M. Araliya – Ground Floor – Alhivilaa Magu,  
20292 Male, Maldives



**Mexico Distributor :**  
**Comercializadora UNIF Sa De CV**  
Contact Person : Tristan Termaat  
E-mail : tristan@unifmexico.com.mx  
Phone : + 52 984 80 311 68  
Mail : Calle 4 nte Mza 42 Lote 4-1 Local B Entre  
25 y 30 Avenida Col. Centro Localidad :  
Playa del Carmen,Q. Roo Municipio :  
Solidaridad CP: 77710 Mexico



**New Zealand Distributor : Sea Tech Ltd.**  
Contact Person : Dave Moran  
E-mail : info@seatech.co.nz  
Phone : 64-9-5210684  
Mail : 47 Tautari St. Orakei, Auckland 1071,  
New Zealand



**Philippines Distributor :**  
**Dive Supply Subic, INC.**  
Contact Person : Rowena Merto  
E-mail : muriel@aquaventurewhitetip.com  
Phone : 63-2-708-9996  
Mail : Office 6&7 EMS Building, 14th Street  
Subic Gate Perimeter Road, Subic Bay  
Freeport Zone, Olongapo City,  
2222 ,Philippines



**Poland Distributor : Waterfall**  
Contact Person : Darek  
E-mail : darek@waterfall.pl  
Phone : 48-600-340-002  
Mail : UL. Klimczaka 22D/3, 02-797 Warszawa  
Poland PL 7621470585



**Scandinavian Distributor : AquaFun AB**  
Contact Person : Sales Office  
E-mail : info@aquafun.se  
Phone : 46-0-40-295-300  
Mail : Sangleksgatan 4E, 215 79, Malmö,  
Sweden



**Singapore Distributor :**  
**Divesea Pte Ltd**  
Contact Person : Fairuz Ahmad  
E-mail : team@divesea.com.sg  
Phone : 65-85115164  
Mail : 90 Lor 23 Geylang  
Agraw Building # 01-03  
Singapore 388393



**South Africa Distributor:**  
**Manex & Power Marine**  
Contact Person : Gavin Jones  
E-mail : gavin.jones@manex.co.za  
Phone : 27-021-511-7292  
Mail : 9 Paarden Eiland Road, Paarden Eiland,  
South Africa



**Spain/ Portugal Distributor :**  
**Custom Diving Systems**  
Contact Person : Yannig Charles  
E-mail : contact@cds-pro.com  
Phone : +33 (0) 6 114 81 114  
Mail : 563, Rue De La Prairie 73350  
Bozel , France



**Switzerland Distributor :**  
**Custom Diving Systems**  
Contact Person : Yannig Charles  
E-mail : contact@cds-pro.com  
Phone : +33 0 6 114 81 114  
Mail : 563, Rue De La Prairie 73350  
Bozel , France



**Russia Distributor : Custom Diving  
Systems**  
Contact Person : Yannig Charles  
E-mail : contact@cds-pro.com  
Phone : + 33 (0) 6 114 81 114  
Mail : 563, Rue De La Prairie 73350  
Bozel , France



**Taiwan Distributor : Indigo Blue Technology  
Co. Ltd.**  
Contact Person : Rachel Cheng  
E-mail : rachel.cheng@weistechnology.com.tw  
Phone : 886 2 82271619  
Mail : 4F-6, No. 258 Lian Cheng Road,  
Chung Ho Dist., New Taipei City 23553  
Taiwan, ROC



**Turkey Distributor : K Pro Doga Sporlari  
Malzemeieri Tic. Ltd. STI**  
Contact Person : Akin Kaftanoglu  
E-mail : akinkaftanoglu@yahoo.com  
Phone : 90-3124334479  
Mail : Bulbulderesi Cad. No.: 23/A, Seyranbaglari,  
Ankara, Turkey



**U.A.E. Distributor : Senyar Marine Equipment**  
Contact Person : Abdulla Al Kindi  
E-mail : senyar7@gmail.com  
Phone : 971-2-666-9999  
Mail : P.O. Box 112790, Abu Dhabi, U.A.E.



**United Kingdom / Ireland Distributor :**  
**Liquid Sports Ltd.**  
Contact Person : Alastair Ansell  
E-mail : alastair@liquidsports.co.uk  
Phone : 44-0-7585-935522  
Mail : 11 Stag Lane, Berkhamsted,  
Hertfordshire, HP4 1FJ, UK



## Headquarters :

### **Bosk International Company Limited**

Contact Person : Oscar Tong

E-mail : [oscar@bigblue.com.hk](mailto:oscar@bigblue.com.hk)

Phone : 852-3568-0773

Fax: 852-3998-3127

Mail : Room 818,8/F, Po Yip Building, 23. Hing Yip Street, Kwun Tong, Hong Kong

### **US Sales Office : BoskUSA / Bigblue Dive Lights**

Contact Person : Tim Ratcliffe

E-mail : [sales@bigbluedivelights.com](mailto:sales@bigbluedivelights.com)

Phone : 727-442-2300

Fax: 727-499-7117

Mail : 1710N Hercules Ave, Suite 103, Clearwater, FL 33765 USA

Website : [www.bigbluelights.com](http://www.bigbluelights.com)  
[www.bigblue.com.hk](http://www.bigblue.com.hk)

Visit Us  
on website



Like Us  
on facebook

